

Pushbutton Switches

Snap-Acting Pushbutton Switches (ON-MOM)

PB1M Series



PB1MSA1B11T1 _ _ _ _

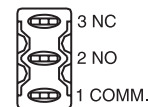
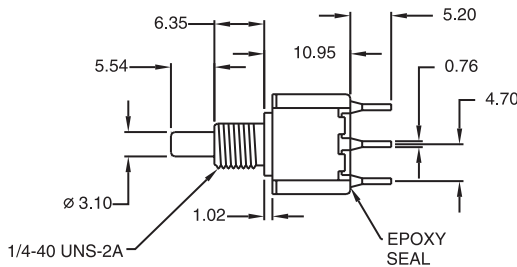
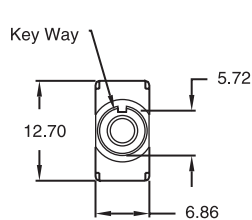

PB1MSA1B20T6 _ _ _ _

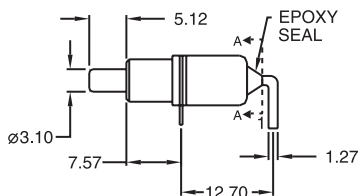
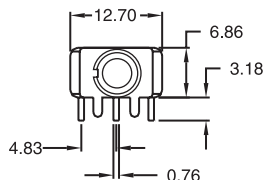

COMM. N.O. N.C.

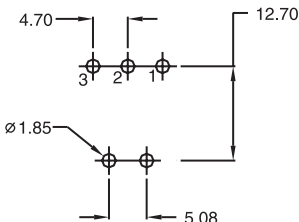
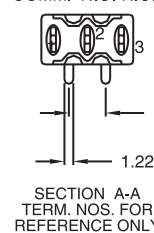

PB1MSA1B20T7 _ _ _ _

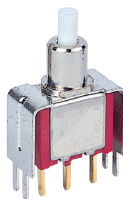
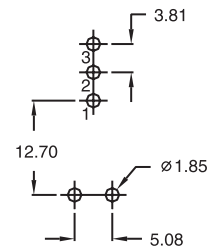
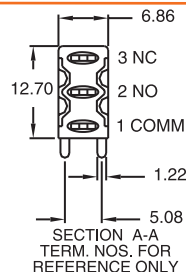
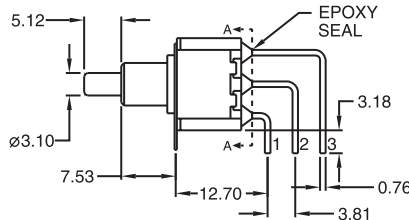
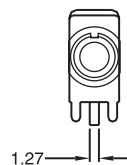

PB1MSA1B20VS2 _ _ _ _

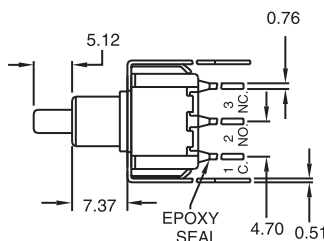
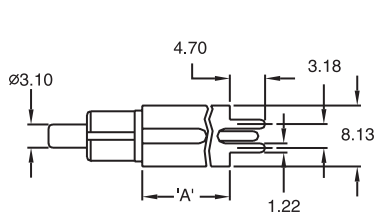

OPTION CODE	DIM. 'A'
VS2	11.68
VS3	16.00

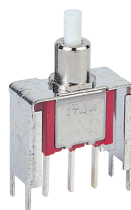
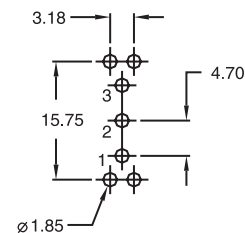

PB1MSA1B20VS4 _ _ _ _

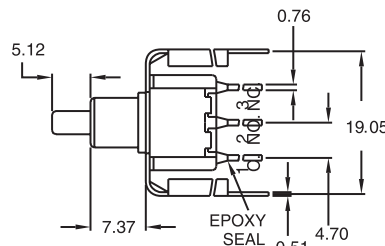
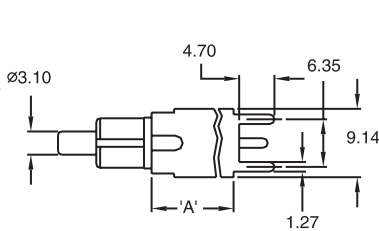

OPTION CODE	DIM. 'A'
VS4	11.68
VS5	16.00

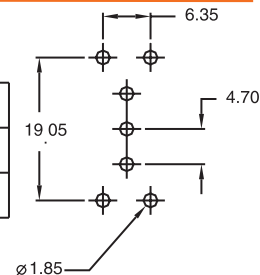

How to order:



1 SWITCHING & POLES:
M5 ON-MOM SPDT
MD ON-MOM DPDT

2 ACTUATOR:
A1 5.54 mm high (Only for B bushings)

3 BUSHING:
B10 6.35mm high, keyway (thd)
B11 6.35mm high, flat (thd)
B20 6.35mm high, keyway (non-thd)
B21 6.35mm high, flat (non-thd)
AP1 Cap only
AP2 Cap frame
AP3 Cap only - (flat)
AP4 Cap frame - (flat)
AP5 Cap with frame for LED, snap-in
AP6 Cap with frame for LED, snap-in (flat)
PA 5.54mm high (metal material)
PB 7.00mm high, 15/32 bushing

4 TERMINALS:
T1 Solder Lug
T2 PC thru-hole
T5 Wire wrap
T6 Right angle, PC thru-hole
T6N Right angle, snap-in, PC thru-hole
T7 Vertical right angle, PC thru-hole

VS2 11.68mm high, V-bracket
V2N 11.68mm high, snap-in, V-bracket
VS3 16.00mm high, V-bracket
VS4 11.68mm high, V-bracket
VS5 16.00mm high, V-bracket

5 CONTACT MATERIAL:
AG Silver
AU Gold
UT Gold, tin-lead
GT Silver, tin-lead
UG Gold over silver
UGT Gold over silver, tin-lead

6 SEAL:
E Epoxy (Standard)
N No Epoxy

7 ROHS & LEAD FREE:
blank RoHS compliant
V RoHS & lead free

8 CAP:
C1 Cap1
C2 Cap2
C3 Cap3
C4 Cap4

General Specifications:

MATERIALS

» Movable Contact & Fixed Terminals:
 AG, GT, UT & UGT: Silver plated over copper alloy
 AU & UT: Gold over nickel plated over copper alloy

MECHANICAL

» Operating Temperature: -30°C to +85°C
 » Mechanical Life: 30,000 cycles

CONTACT RATING

» AG, GT, UG & UGT: 3A 120VAC/28VDC
 1A 250VAC
 » AU & UT: 0.4VA max. 20V max. (AC/DC)

ELECTRICAL

» Contact Resistance: 20mΩ max. initial @ 2-4VDC
 100mA for silver & gold plated contacts
 » Insulation Resistance: 1,000MΩ min.

Pushbutton Switches

Snap-Acting Pushbutton Switches (ON-MOM)

PB1M Series

Pushbutton Switches

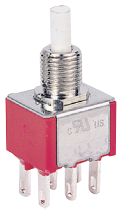

PB1MDA1B10T1

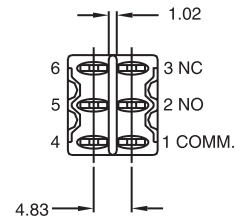
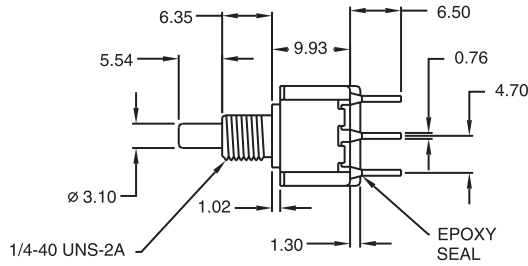
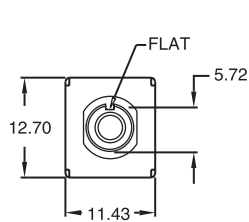

PB1MDA1B20T6

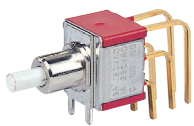
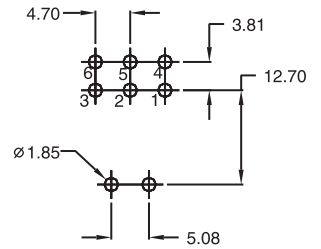
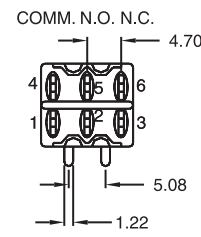
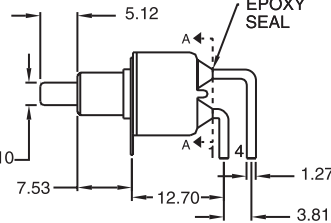
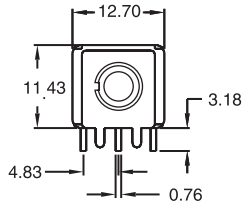

PB1MDA1B20T7

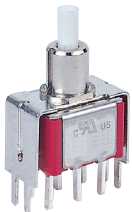
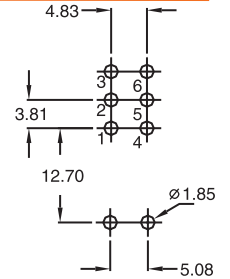
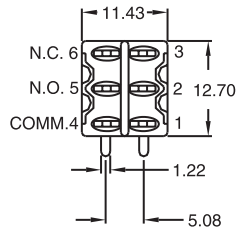
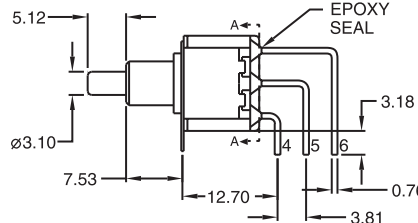
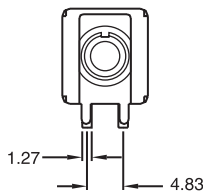

PB1MDA1B20VS2

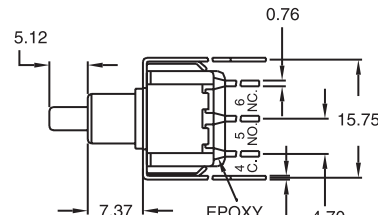
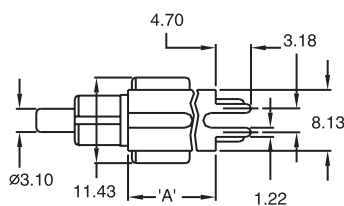

OPTION CODE	DIM. 'A'
VS2	11.68

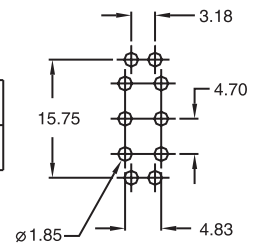

PB1MDA1B20VS4

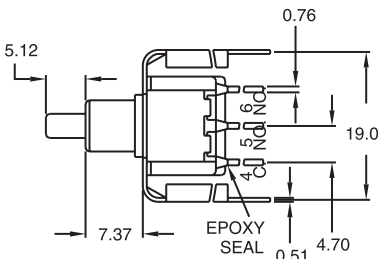
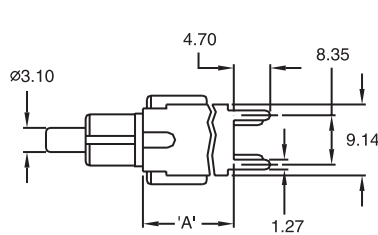

OPTION CODE	DIM. 'A'
VS4	11.68
VS5	16.00

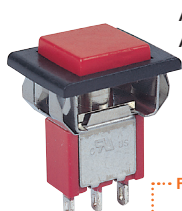
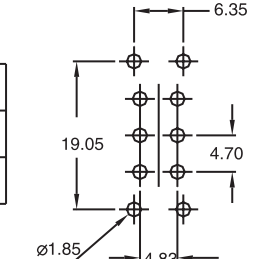

PB1MSAP2

AP2: Cap & Frame
AP1: Cap only

A	BLACK
B	WHITE
C	RED
D	ORANGE
E	YELLOW
F	GREEN
G	BLUE
K	BROWN
H	GRAY

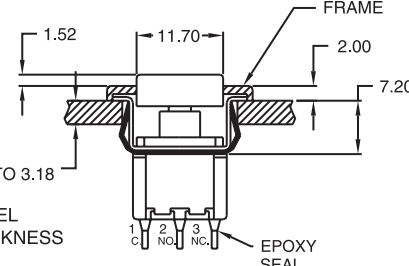
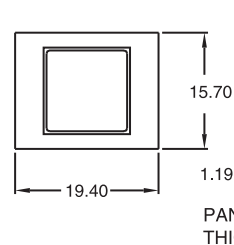

INCREASE TO 15.75/15.88 FOR 2.31/3.18 THK PANEL R0.13

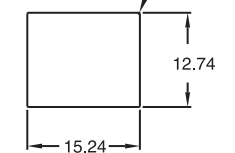

PANEL LAYOUT

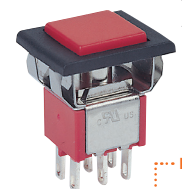

PB1MDAP2

AP2: Cap & Frame
AP1: Cap only

A	BLACK
B	WHITE
C	RED
D	ORANGE
E	YELLOW
F	GREEN
G	BLUE
K	BROWN
H	GRAY

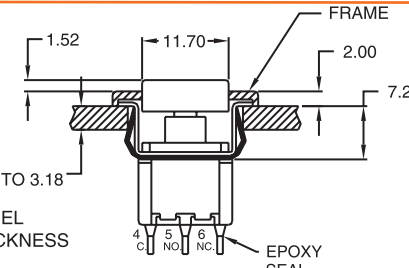
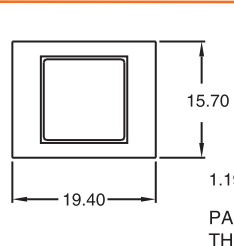

INCREASE TO 15.75/15.88 FOR 2.31/3.18 THK PANEL R0.13

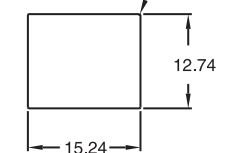

PANEL LAYOUT

Pushbutton Switches

Snap-Acting Pushbutton Switches (ON-MOM)

PB1M Series

Pushbutton Switches



AP4: Cap & Frame
AP3: Cap only

FRAME COLOR
CAP COLOR

PB1MSAP4 □ □ T1

A	BLACK
B	WHITE
C	RED
D	ORANGE
E	YELLOW
F	GREEN
G	BLUE
K	BROWN
H	GRAY

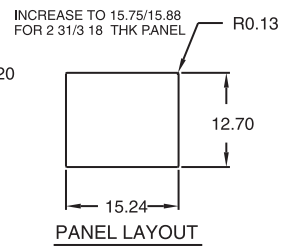
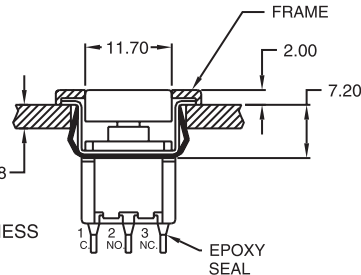
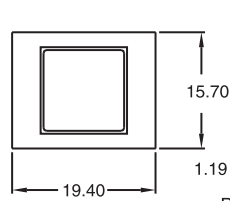
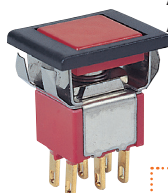



AP4: Cap & Frame
AP3: Cap only

FRAME COLOR
CAP COLOR

PB1MDAP4 □ □ T1

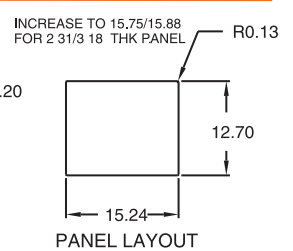
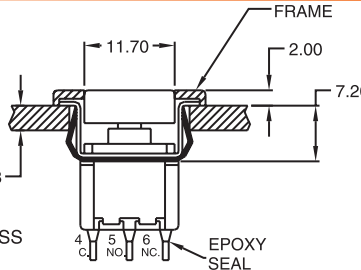
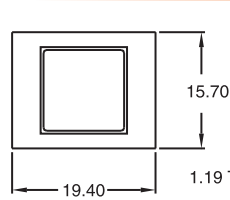
A	BLACK
B	WHITE
C	RED
D	ORANGE
E	YELLOW
F	GREEN
G	BLUE
K	BROWN
H	GRAY





AP5: Cap & FRAME

LED COLORS:
FRAME COLOR
CAP COLOR

PB1MSAP5 □ □ T1

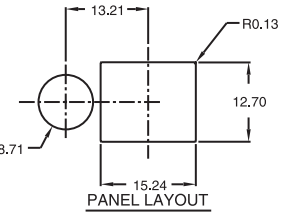
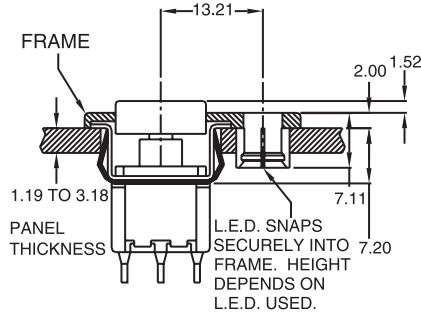
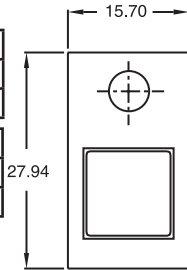
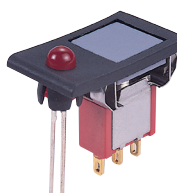
A	BLACK
B	WHITE
C	RED
D	ORANGE
F	GREEN





AP5: Cap & FRAME

LED COLORS:
FRAME COLOR
CAP COLOR

PB1MSAP5 □ □ T1

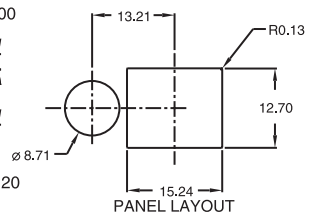
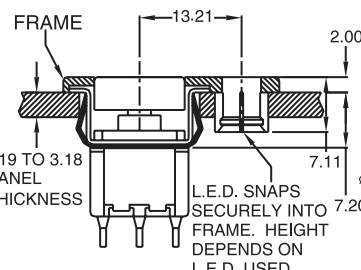
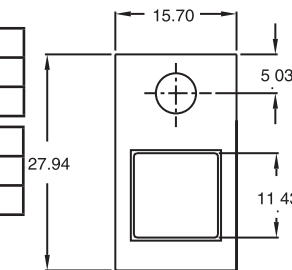
A	BLACK
B	WHITE
C	RED
D	ORANGE
F	GREEN

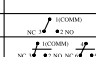

		SWITCH FUNCTION		CONNECTED TERMINALS		SCHEMATIC
NO. POLES	MODEL NO.	POS.1	POS.2	POS.1	POS.2	
SP	PB1MS	ON	MOM	1-3	1-2	
DP	PB1MD	ON	MOM	1-3,4-6	1-2,4-5	

MOM=MENTORARY

TERMINAL OPTIONS

T1 Solder Lug

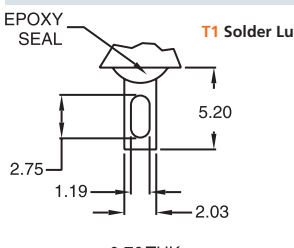

5.20, 2.75, 1.19, 2.03, 0.76 THK.

T2 PC Thru Hole

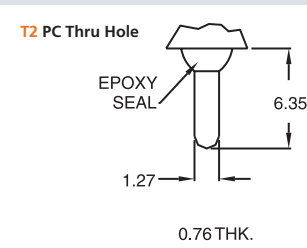

6.35, 1.27, 0.76 THK.

T3 Quick Connect

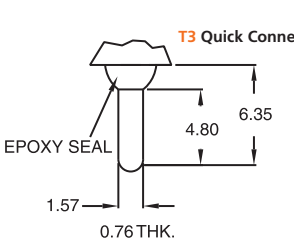

6.35, 4.80, 1.57, 0.76 THK.

T5 Wire Wrap

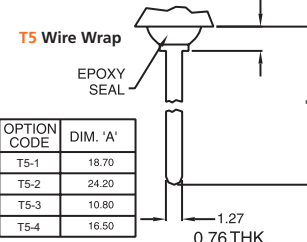

1.91, 'A', 1.27, 0.76 THK.

OPTION CODE	DIM. 'A'
T5-1	18.70
T5-2	24.20
T5-3	10.80
T5-4	16.50

BUSHING OPTIONS

B10 THD STD
B20 NON THD

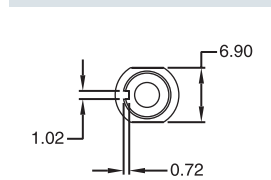

6.90, 1.02, 0.72

1/4-40 UNS-2A

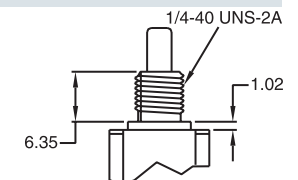

1.02, 6.35

B11 THD STD
B21 NON THD

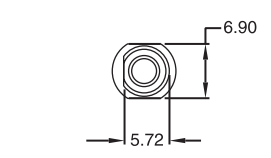

6.90, 5.72

1/4-40 UNS-2A

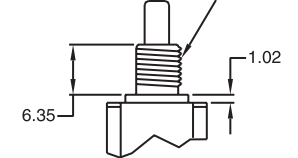

1.02, 6.35

SNAP-IN TERMINAL OPTIONS

T6N

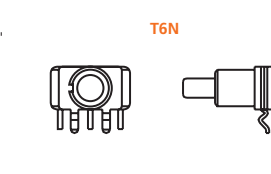

V2N

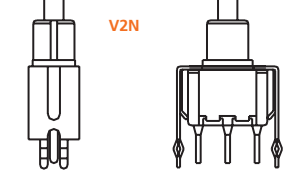

Pushbutton Switches

Snap-Acting Pushbutton Switches (ON-ON)

PB1N Series



PB1NSA1B60T1

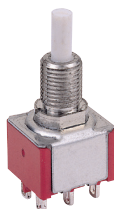
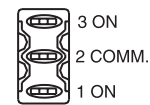
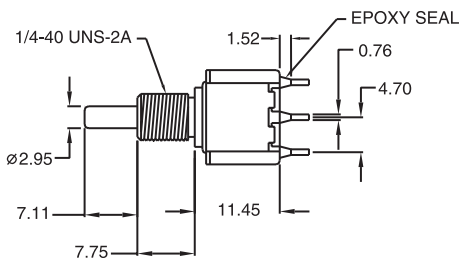
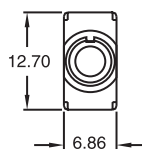

PB1NDA1B60T1

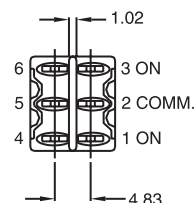
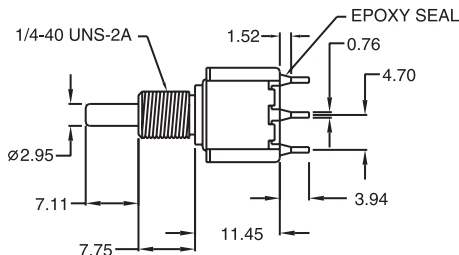
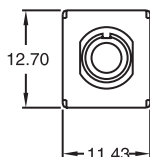

PB1NSA1B70T6

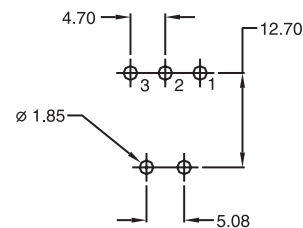
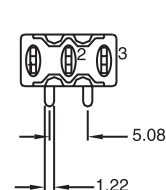
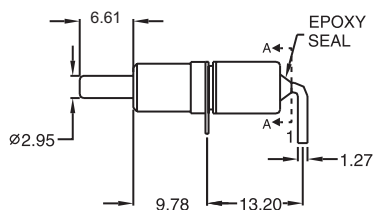
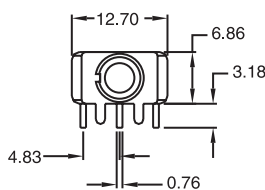

PB1NDA1B70T6

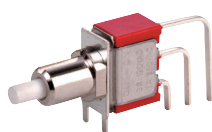
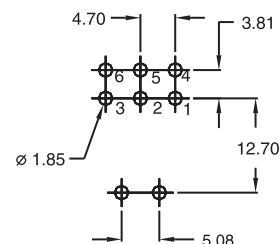
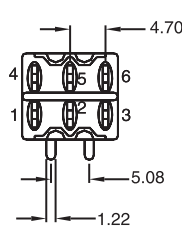
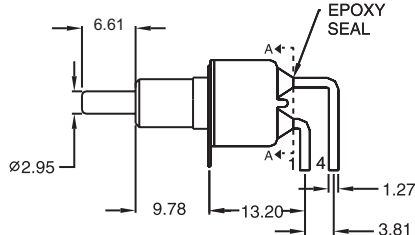
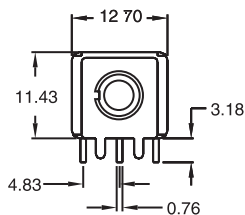

PB1NSA1B70T7

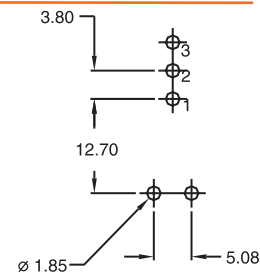
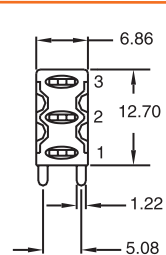
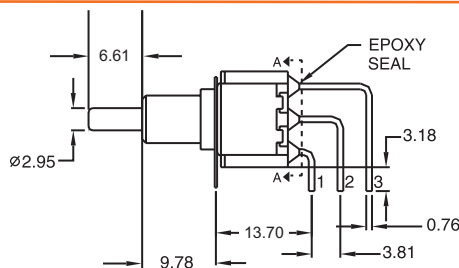
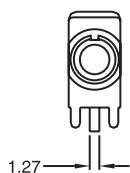

How to order:

PB1

1 SWITCHING & POLES:
 NS ON-ON SPDT
 ND ON-ON DPDT

2 ACTUATOR:
 A1 6.61/7.11 mm high
 AA Handle, metal material
 AB Handle, metal material

3 BUSHING:
 B60 7.62mm high, keyway (thd)
 B61 7.62mm high, flat (thd)
 B70 7.62mm high, keyway (non-thd)
 B71 7.62mm high, flat (non-thd)

4 TERMINALS:
 T1 Solder Lug
 T2 PC thru-hole
 T5 Wire wrap
 T6 Right angle, PC thru-hole

T6N Right angle, PC thru-hole
T7 Right angle, snap-in, PC thru-hole
VS2 Vertical right angle, PC thru-hole
V2N 11.68mm high, V-bracket
VS3 11.68mm high, snap-in, V-bracket
VS4 16.00mm high, V-bracket
VSS 11.68mm high, V-bracket
VS5 16.00mm high, V-bracket

5 CONTACT MATERIAL:
 AG Silver
 AU Gold
 UT Gold, tin-lead
 GT Silver, tin-lead
 UG Gold over silver
 UGT Gold over silver, tin-lead

6 SEAL:
 E Epoxy (Standard)
 N No Epoxy

7 ROHS & LEAD FREE:
 blank RoHS compliant
 V RoHS & lead free

8 CAP:
 C1 Cap1
 C2 Cap2
 C3 Cap3
 C4 Cap4

General Specifications:

MATERIALS

» Movable Contact & Fixed Terminals:
 AG, GT, UG & UGT: Silver plated over copper alloy
 AU & UT: Gold over nickel plated over copper alloy

MECHANICAL

» Operating Temperature: -30°C to +85°C
 » Mechanical Life: 30,000 cycles

CONTACT RATING

» AG, GT, UG & UGT: 3A 120VAC/28VDC
 1A 250VAC
 » AU & UT: 0.4VA max. 20V max. (AC/DC)

ELECTRICAL

» Contact Resistance: 20mΩ max. initial @ 2-4VDC
 100mA for silver & gold plated contacts
 » Insulation Resistance: 1,000MΩ min.

Pushbutton Switches

Snap-Acting Pushbutton Switches (ON-ON)

PB1N Series

Pushbutton Switches

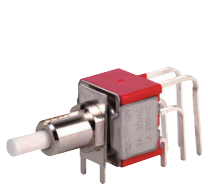

PB1NDA1B70T7

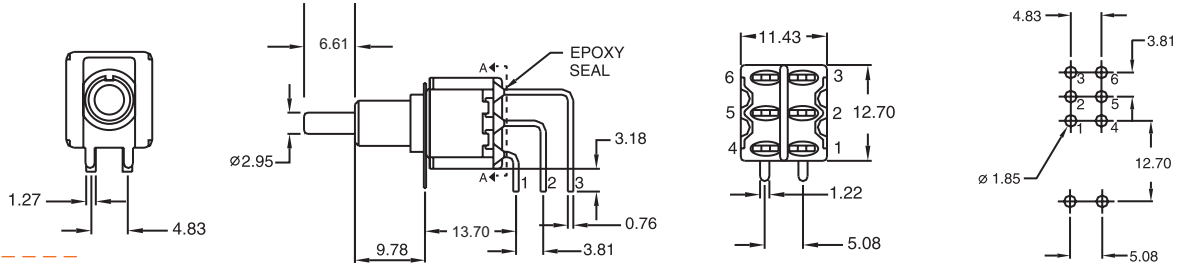

PB1NSA1B70VS2

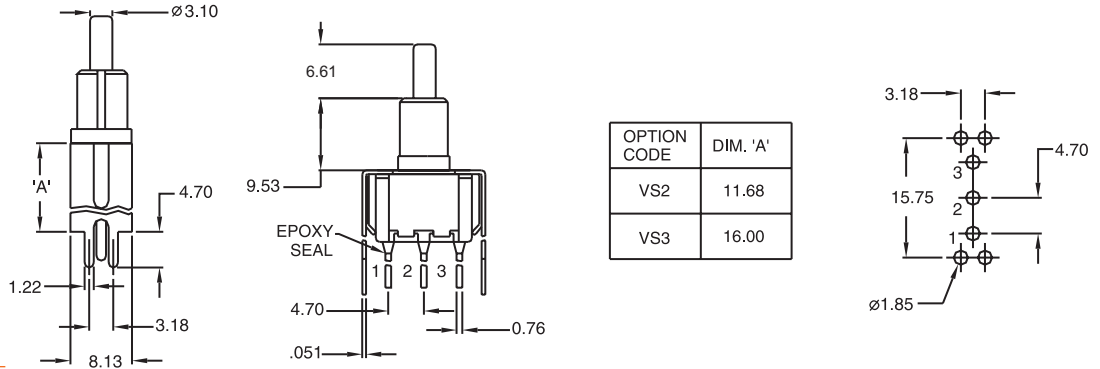

PB1NDA1B70VS2

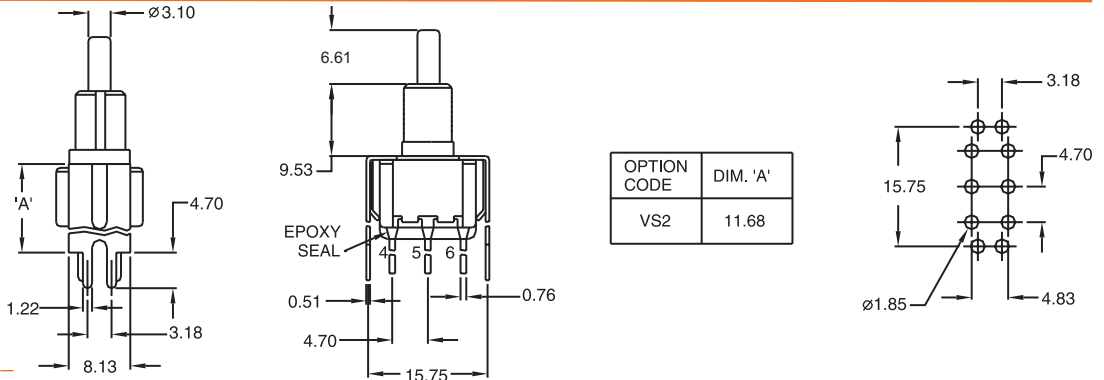

CAPS (Colors: white, black, green, red)



SWITCH FUNCTION

NO. POLES	MODEL NO.	SWITCH FUNCTION		CONNECTED TERMINALS/SCHEMATIC	
		POS.1	POS.2	POS.1	POS.2
SP	PB1NS	ON	ON	1-2	2-3
DP	PB1ND	ON	ON	1-2,4-5	2-3,5-6

TERMINAL OPTIONS

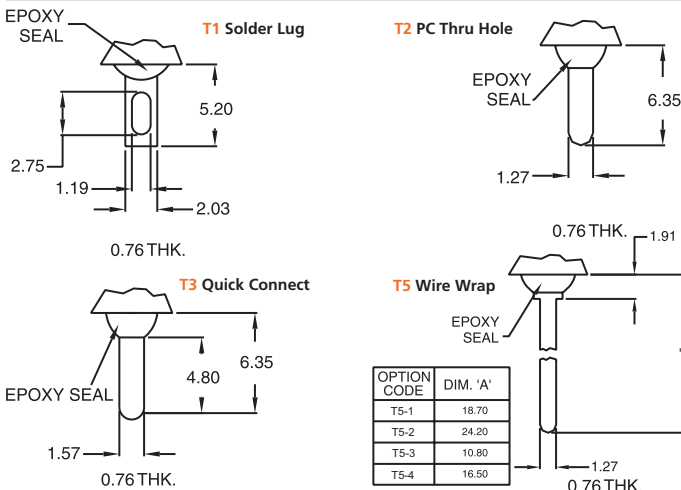

BUSHING OPTIONS

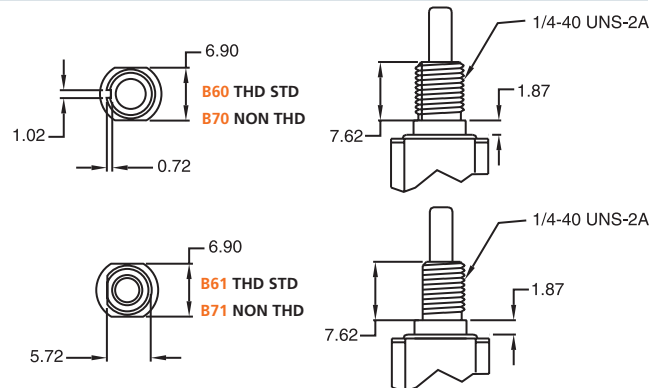

SNAP-IN TERMINAL OPTIONS

