

Rocker Switches

24 x 21 mm Rocker Switches

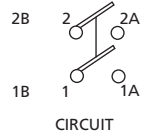

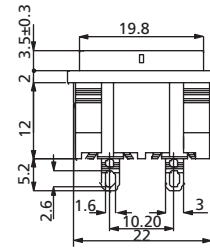
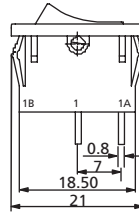
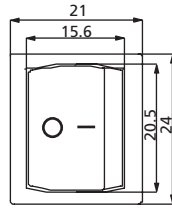

RK1 Series

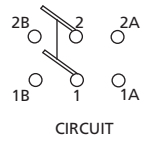
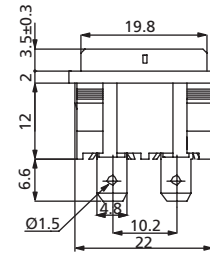
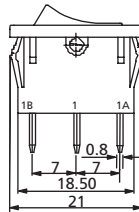
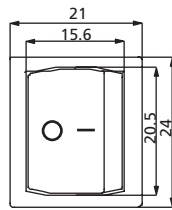
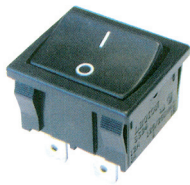

RK1D1D4 ___ Double Pole, Solder Tag Terminals

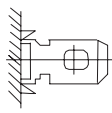
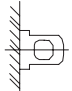
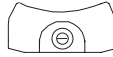

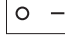
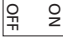
RK1D6Q4 ___ Double Pole, Quick Connect Terminals

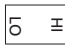
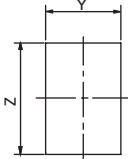
TERMINAL	ACTUATOR	ACTUATOR MARKING	PANEL SIZE												
Q 4.8mm TAB, 0.8mm Thick  D Solder Tag 	4 Curve 	A  D  B  E  C  F  S "Special"	 <table border="1"> <thead> <tr> <th>X (Panel thickness)</th> <th>Dimension Y</th> <th>Dimension Z</th> </tr> </thead> <tbody> <tr> <td>0.8 to 1.2 mm</td> <td>19.20 +0/-0.1 mm</td> <td>21.90 +0/-0.1 mm</td> </tr> <tr> <td>1.3 to 2.0 mm</td> <td>19.40 +0/-0.1 mm</td> <td>21.90 +0/-0.1 mm</td> </tr> <tr> <td>2.1 to 3.0 mm</td> <td>19.80 +0/-0.1 mm</td> <td>21.90 +0/-0.1 mm</td> </tr> </tbody> </table>	X (Panel thickness)	Dimension Y	Dimension Z	0.8 to 1.2 mm	19.20 +0/-0.1 mm	21.90 +0/-0.1 mm	1.3 to 2.0 mm	19.40 +0/-0.1 mm	21.90 +0/-0.1 mm	2.1 to 3.0 mm	19.80 +0/-0.1 mm	21.90 +0/-0.1 mm
X (Panel thickness)	Dimension Y	Dimension Z													
0.8 to 1.2 mm	19.20 +0/-0.1 mm	21.90 +0/-0.1 mm													
1.3 to 2.0 mm	19.40 +0/-0.1 mm	21.90 +0/-0.1 mm													
2.1 to 3.0 mm	19.80 +0/-0.1 mm	21.90 +0/-0.1 mm													

How to order:

RK1

- 1** **POLES:**
S Single Pole (SP)
D Double Poles (DP)
- 2** **SWITCHING:**
1 ON - OFF
6 ON - NONE - ON
- 3** **TERMINAL (See above drawings):**
Q 4.8mm TAB, 0.8mm THICK
D Solder Tag
- 4** **ACTUATOR (See above drawings):**
4 Curve
- 5** **ACTUATOR MARKING**
A See above drawings
B See above drawings
C See above drawings
D See above drawings
E See above drawings
F See above drawings
S See above drawings
- 6** **BASE COLOR:**
A Black
H Grey
B White
- 7** **ACTUATOR COLOR:**
A Black
H Grey
B White
F Green
D Orange
C Red

General Specifications:

- FEATURES**
 » Single & double poles rocker switch up to 16A 250VAC
- MATERIALS**
 » Contact: Silver alloy
 » Terminals: Silver plated copper
- MECHANICAL**
 » Spring: Piano wire
 » Temperature Range: -20°C to +125°C
- ELECTRICAL**
 » Rating: 12A 125/250VAC
 16(4)A 250V
 » Electrical Life: 10,000 cycles
 » Initial Contact Resistance: 30mΩ max.
 » Insulation Resistance: 100MΩ min. at 500VDC