

Rotary Switches

10 x 10 mm Sealed Rotary DIP Switches (THR)

RD82T Series

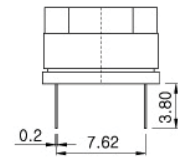
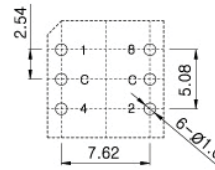
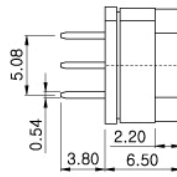
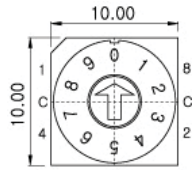

RD82THR

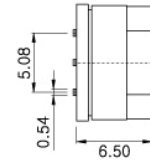
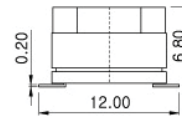
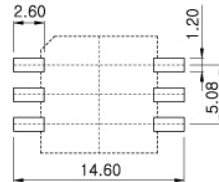
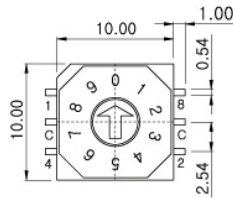

RD82TSO

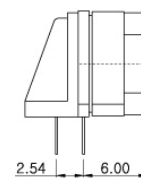
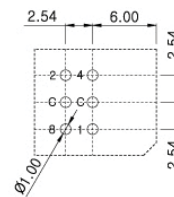
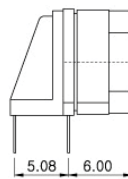
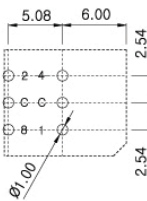
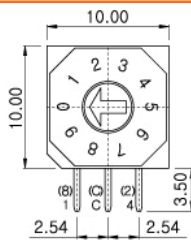

RD82TA20

ROTOR TYPE

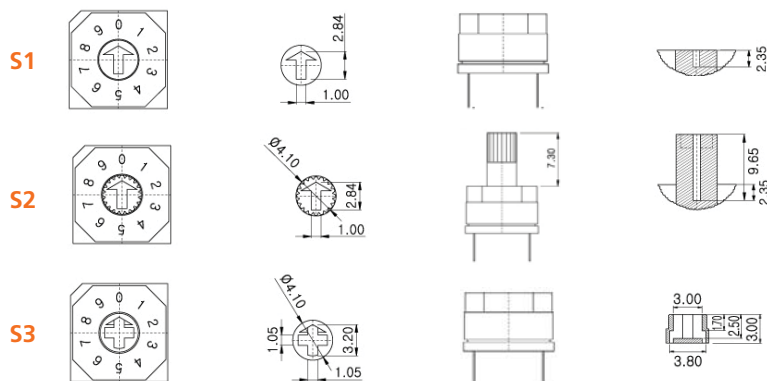

ACCESSORIES

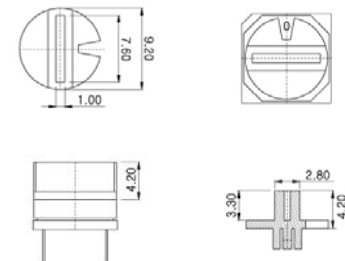

AK - 83 (applicable to only "S3" actuators)

H: Grey C: Red A: Black

How to order:

RD82T

- | | |
|---|-----------------------------|
| 1 TYPE OF TERMINALS: | 4 NO. OF POSITIONS: |
| H THT Top Adjust Type | 04 4 Positions |
| A1 THT Right Angle Side Adjust Type with Rows Spacing 2.54 mm | 06 6 Positions |
| A2 THT Right Angle Side Adjust Type with Rows Spacing 5.08 mm | 08 8 Positions |
| S SMT Top Type | 10 10 Positions |
| 2 TYPE OF CASE: | 16 16 Positions |
| O Octagon Type | 5 CODE (See Page 2): |
| R Round Type | R Real Code |
| 3 ROTOR TYPE (See Above Drawings): | S Complementary Code |
| S1 Arrow Type | G Gray Code |
| S2 Shaft Type | NR Special Code 1 |
| S3 Cross Type | NS Special Code 2 |
| | ND Special Code 3 |
| | NE Special Code 4 |
| | 6 PACKAGING TYPE: |
| | TB Tube |
| | TR Tape & Reel (SMT Only) |

General Specifications:

FEATURES

- » Sealing: IP 67(Dust & Waterproof)
- » THR (Thru Hole Reflow solderable)
- » 3 x 3 Terminal

MECHANICAL

- » Life Cycle: 10,000 steps
- » Operating Force: 700 gf max.

ELECTRICAL

- » Contact Rating: 150mA, 24V DC (Switching)
400mA, 24V DC (None-Switching)
- » Contact Resistance: 80mΩ Max
- » Insulation Resistance: 100MΩ Min

SOLDERING CONDITIONS

- Solder reflow max: 10s./260°C
- Solder iron max: 2s./340°C
- Solder bath max: 5s/280°C

Rotary Switches

10 x 10 mm Sealed Rotary DIP Switches (THR)

RD82T Series

CODE

Real Code

	04 Position	Real Code					
	0	C	1	2			
	1						
	2						

	06 Position	Real Code					
	0	C	1	2	4	8	
	1						
	2						
	3						

	08 Position	Real Code					
	0	C	1	2	4	8	
	1						
	2						
	3						
	4						
	5						

	10 Position	Real Code					
	0	C	1	2	4	8	
	1						
	2						
	3						
	4						
	5						
	6						
	7						

	16 Position	Real Code					
	0	C	1	2	4	8	
	1						
	2						
	3						
	4						
	5						
	6						
	7						
	8						
	9						
	10						A
	11						B
	12						C
	13						D
14						E	
15						F	

Complementary Code

	04 Position	Complement Code			
	0	C	1	2	
	1				
	2				

	06 Position	Complement Code				
	0	C	1	2	4	8
	1					
	2					
	3					

	08 Position	Complement Code				
	0	C	1	2	4	8
	1					
	2					
	3					
	4					
	5					

	10 Position	Complement Code				
	0	C	1	2	4	8
	1					
	2					
	3					
	4					
	5					
	6					
	7					

	16 Position	Complement Code					
	0	C	1	2	4	8	
	1						
	2						
	3						
	4						
	5						
	6						
	7						
	8						
	9						
	10						A
	11						B
	12						C
	13						D
14						E	
15						F	

Gray Code

	10 Position	Gray Code				
	0	C	1	2	4	8
	1					
	2					
	3					
	4					
	5					
	6					
	7					
	8					

	16 Position	Gray Code					
	0	C	1	2	4	8	
	1						
	2						
	3						
	4						
	5						
	6						
	7						
	8						
	9						
	10						A
	11						B
	12						C
	13						D
14						E	
15						F	

Special Code

	NR	Real Code				
	0	C	1	2	4	8
	1					
	2					
	3					
	4					
	5					
	6					
	7					
	8					

	NS	Complement Code					
	0	C	1	2	4	8	
	1						
	2						
	3						
	4						
	5						
	6						
	7						
	8						
	9						
	10						A
	11						B
	12						C
	13						D
14						E	
15						F	

	ND	Dezimal				
	0	C	1	2	3	4
	1					
	2					

	NE	Real Code				
	0	C	1	2	4	8
	1					
	2					
	3					