

Toggle Switches

Sealed Miniature Toggle Switch

P/N: TK21S1A8B22T1AUEV

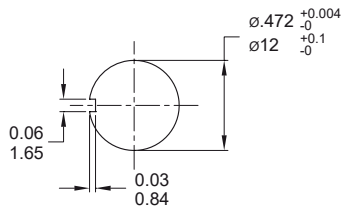
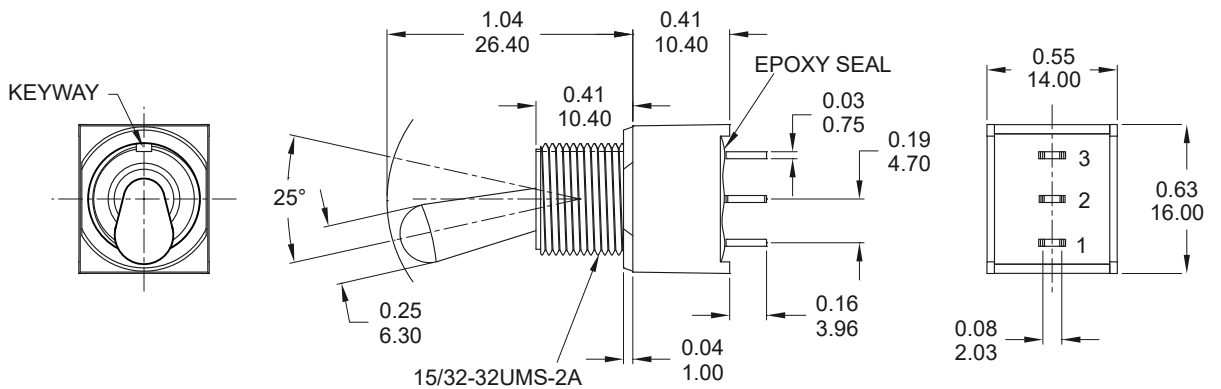

PANEL MOUNTING

	POS.1	POS.2	POS.3
Term. Comm.	ON	NONE	ON
	2-3	N/A	2-1
SCHEMATIC			

SWITCH FUNCTION

Sealing Boots

P/N: 21A-PG2A

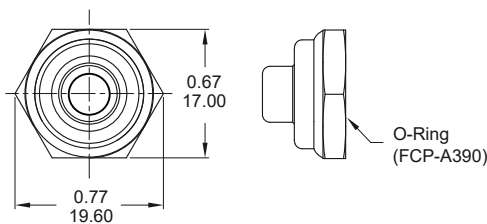

HARDWARE

21A-PG2A

SPECIFICATIONS

CONTACT RATING: 0.4Volt-Amps(VA) max.@20V max(AC or DC)

MECHANICAL LIFE: 100,000 make-and-break cycles.

ELECTRICAL LIFE: 50,000 cycles.

CONTACT RESISTANCE: 10 mΩ max. initial @ 2-4VDC
100mA for both silver and gold plated contacts.

INSULATION RESISTANCE: 1,000 MΩ min.

DIELECTRIC STRENGTH: 1,000 V RMS@sea level.

OPERATING TEMPERATURE: -30°C to 85°C.

MATERIALS

CASE & BUSHING: Glass filled nylon 6/6, flame retardant, heat stabilized (UL94v-0).

ACTUATOR: Brass, chrome plated with internal, O-ring seal standard.

SWITCH SUPPORT: Brass or steel, tin plated.

CONTACT / TERMINALS: Copper alloy, gold plated.

SEALIND: IP67.



TOLERANCE (公差):
0.00 mm ± 0.25mm
0.0 mm ± 0.40mm
ANGULAR : ± 5°