

Rocker Switches

21x15mm SP illuminated Rocker Switches IP68

RK3W Series

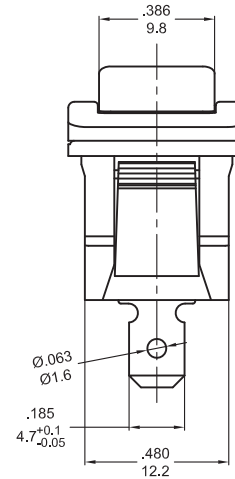
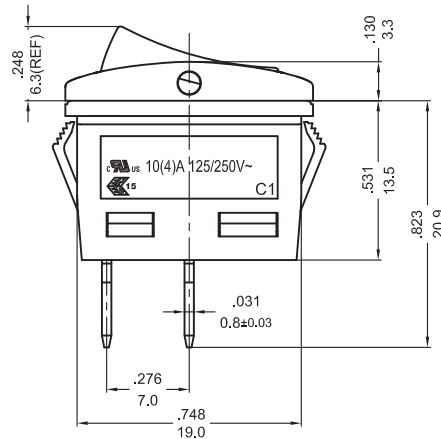
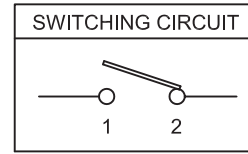
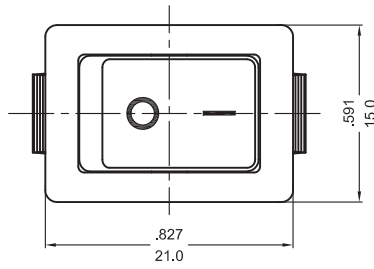

TERMINAL

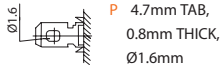

P 4.7mm TAB,
0.8mm THICK,
Ø1.6mm

ACTUATOR

4 Curve
(No Illuminated)



ACTUATOR MARKING

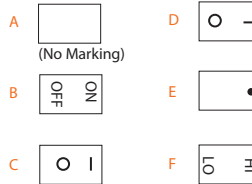

PANEL SIZE

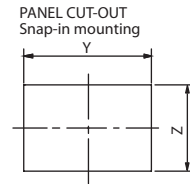

X (Panel thickness)	Dimension Y	Dimension Z
0.75 to 1.25 mm	19.20 +0.1/-0 mm	12.90 +0.15/-0 mm
1.25 to 2 mm	19.40 +0.1/-0 mm	12.90 +0.15/-0 mm
2 to 3 mm	19.80 +0.1/-0 mm	12.90 +0.15/-0 mm

How to order:



- 1 POLES:**
S Single Pole
- 2 SWITCHING:**
1 ON - OFF
2 ON - ON
- 3 TERMINAL (See above drawings):**
Q 4.7mm TAB, 0.8mm Thick, Ø1.6mm
- 4 ACTUATOR (See above drawings):**
4 Curve (No Illuminated)
- 5 ACTUATOR MARKING:**
A See above drawings
B See above drawings
C See above drawings
D See above drawings
E See above drawings
F See above drawings
- 6 ILLUMINATION:**
N No Illuminated
- 7 BASE COLOR:**
A Black
B White
- 8 ACTUATOR COLOR:**
A Black
B White

General Specifications:

FEATURES

Full waterproof IP68

MATERIALS

Contact Arm: Silver cadmium alloy

Terminal: Silver plated copper

Spring: Piano wire

MECHANICAL

Temperature Range: -20°C to +125°C

ELECTRICAL

Electrical Life: 10,000 cycles

Rating: 10(4)A 125/250V~T55, (cURs,ENEC15)

16(8)A 125/250V~T55, (cURs,ENEC15)

16RA 30VDC T55, IP68 (cURs,ENEC15)

Initial Contact Resistance: 20m Ω max.

Insulation Resistance: 100M Ω min. at 500VDC