

Toggle Switches

Sealed Miniature 3PDT Toggle Switches

TK23 Series

UL version available by request

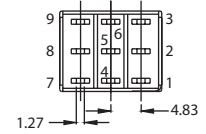
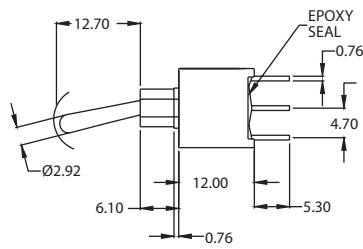
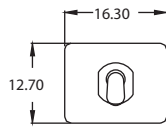

TK23T1A1B4T2_E_ THT Straight

UL version available by request

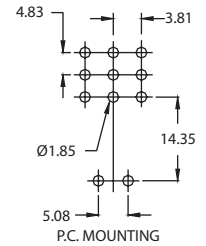
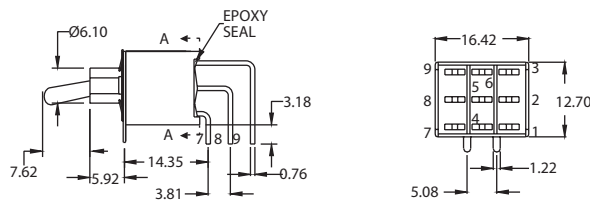
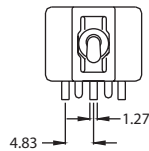

TK23T1A2B4T7_E_ THT Vertical Right Angle

UL version available by request

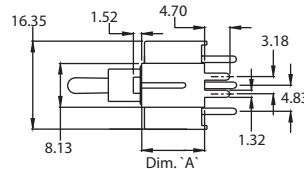
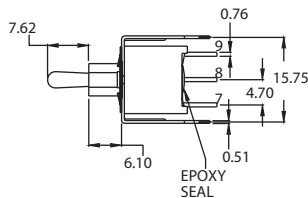

CODE	DIM. A'
VS2	11.68
VS3	16.00

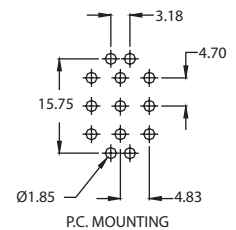

TK23T1A2B4VS2_E_ THT with V-Bracket

No. Poles	Model No.	Switch Function			Connected Terminals / Schematic		
		Position 1	Position 2	Position 3	Position 1	Position 2	Position 3
3P	TK23T1	ON	NONE	ON	2-3	N/A	2-1
3P	TK23T2	ON	NONE	MOM			
3P	TK23T3	ON	OFF	ON		OPEN	
3P	TK23T4	MOM	OFF	MOM			
3P	TK23T5	ON	OFF	MOM			

How to order:

TK23 1 2 3 4 5 6 7

- 1 POLES & SWITCH FUNCTION:**
T1 3P ON-NONE-ON
T2 3P ON-NONE-MOM
T3 3P ON-OFF-ON
T4 3P MOM-OFF-MOM
T5 3P ON-OFF-MOM

- 2 ACTUATOR (Details see page A08):**
A1 Height=12.70 mm
A2 Height=7.62 mm
AA Height=12.70 mm, plastic, anti-static, black
AB Height=7.62 mm, plastic, anti-static, black
AC Height=12.70 mm, plastic, anti-static, silver

- 3 BUSHING (Details see page A08):**
B1 Height = 8.80 mm
B4 Height = 6.10 mm

- 4 TERMINALS (Details see page A08):**
T1 Solder Lug
T2 PC Thru Hole
T51 Wire Wrap, Height = 18.70 mm
T52 Wire Wrap, Height = 24.20 mm

- T53** Wire Wrap, Height = 10.55 mm
T54 Wire Wrap, Height = 26.97 mm
T6 PC Thru Hole, Right Angle
T6N PC Thru Hole, Right Angle, Snap-in
T7 PC Thru Hole, Vertical Right Angle
VS2 V-Bracket, Height = 11.68 mm
V2N Snap-in V-Bracket, Height = 11.68 mm
VS3 V-Bracket, Height = 16.00 mm

- 5 CONTACT MATERIAL:**
AG Silver
AU Gold
UT Gold, Tin-lead
GT Silver, Tin-lead
UG Gold over Silver
UGT Gold over Silver, Tin-lead

- 6 EPOXY:**
E Epoxy (Standard)

- 7 ROHS & LEADFREE:**
blank RoHS compliant (Standard)
V RoHS compliant & Leadfree

General Specifications:

MATERIALS

» Movable Contact & Fixed Terminals:

- AG, GT, UG & UGT:** Silver plated over copper alloy
- AU & UT:** Gold over nickel plated over copper alloy

MECHANICAL

- » Operating Temperature: -30°C to +85°C
- » Mechanical Life: 30,000 cycles
- » Degree of Protection: IP67

CONTACT RATING

- » **AG, GT, UG & UGT:** 5A120VAC/28VDC
2A250VAC
- » **AU & UT:** 0.4VA max. 20V max. (AC/DC)

ELECTRICAL

- » Contact Resistance: 10mΩ max. initial @ 2-4VDC
100mA for silver & gold plated contacts
- » Insulation Resistance: 1,000M Ω min.

Toggle Switches

Additional Informations for TK21, 22 & 23 Series

ACTUATOR OPTIONS

A1 Standard when order with T1 & T2 Terminations	A2 Standard with T6, T7, VS2 & VS3 Terminations	AA ESD Plastic Actuator	AB ESD Plastic Actuator

BUSHING OPTIONS

B1 Standard for T1 termination	B4 Standard for T2, T6, T7 & VS Terminations

TERMINAL OPTIONS

				<table border="1"> <thead> <tr> <th>CODE</th> <th>DIM. 'A'</th> </tr> </thead> <tbody> <tr> <td>T51</td> <td>18.70</td> </tr> <tr> <td>T52</td> <td>24.20</td> </tr> <tr> <td>T53</td> <td>10.55</td> </tr> <tr> <td>T54</td> <td>26.97</td> </tr> </tbody> </table>	CODE	DIM. 'A'	T51	18.70	T52	24.20	T53	10.55	T54	26.97
CODE	DIM. 'A'													
T51	18.70													
T52	24.20													
T53	10.55													
T54	26.97													
T1 Solder Lug	T2 THT	T3 Quick Connect	T5 Wire Wrap											

T6N	T7N	V2N

HARDWARE

NUT	LOCKING RING	LOCK WASHER