

# Detector Switches

## Horizontal SMT Detector Switches

## DF2 Series

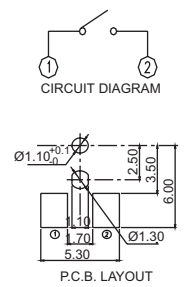
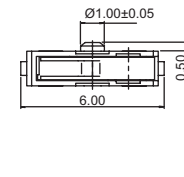
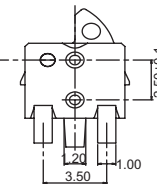
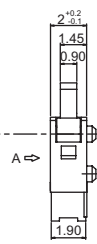
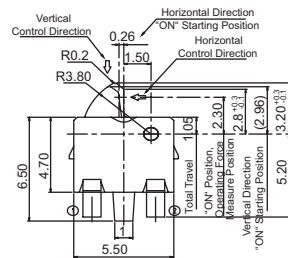

**DF2LN** Left Side Operating, without Ground Terminal

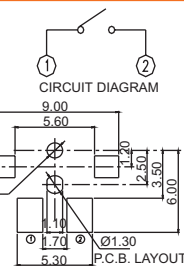
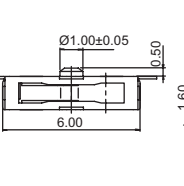
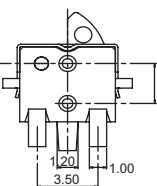
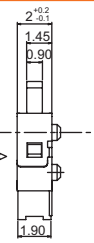
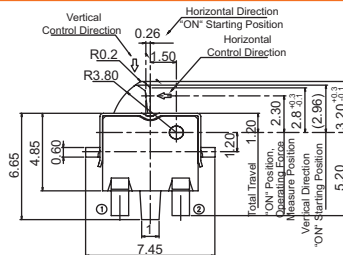

**DF2LG** Left Side Operating, with Ground Terminal

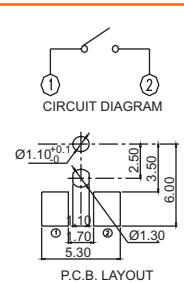
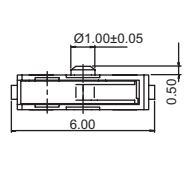
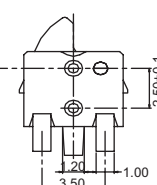
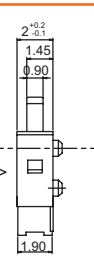
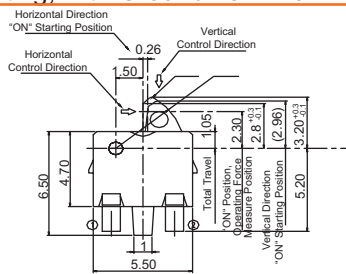
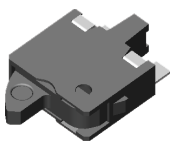

**DF2RN** Right Side Operating, without Ground Terminal

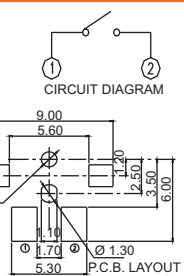
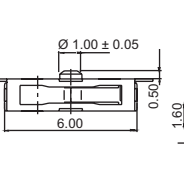
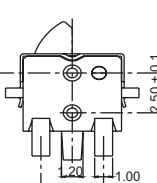
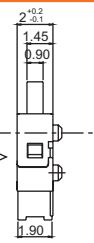
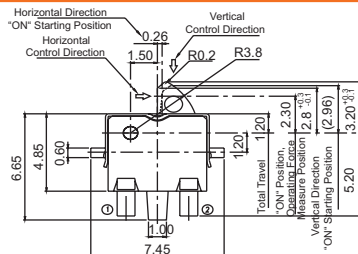
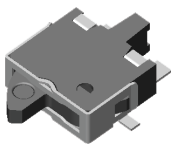

**DF2RG** Right Side Operating, with Ground Terminal

### How to order:

DF2 1 2 3

#### 1 OPERATING DIRECTION:

- L Left Side
- R Right Side

#### 2 GROUND TERMINAL:

- N Without Ground Terminal (Standard)
- G With Ground Terminal

#### 3 PACKAGE STYLE:

- TR Tape & Reel

### General Specifications:

#### FEATURES

- » Compact detector switch with smooth switching action
- » Side operating direction stem
- » Surface Mounting Type in tape & reel package

#### MATERIALS

- » Contact: Stainless steel with silver plated
- » Terminal: Brass with silver plated

#### MECHANICAL

- » Operation Force: 40 gf max.
- » Stroke: 2.15 mm max
- » Operation Temperature: -40°C to +85°C
- » Storage Temperature: -40°C to +85°C

#### ELECTRICAL

- » Electrical Life: 50,000 cycles
- » Rating: 50mA, 20VDC
- » Circuit Arrangement: 1 pole 1 throw

#### SOLDERING PROCESSES

- » Reflow Soldering: When applying reflow soldering, the peak temperature or the reflow oven should be set to 260°C 10 seconds max.

General Tolerance: ± 0.2 mm