

Detector Switches

Horizontal SMT Detector Switches

DF3 Series

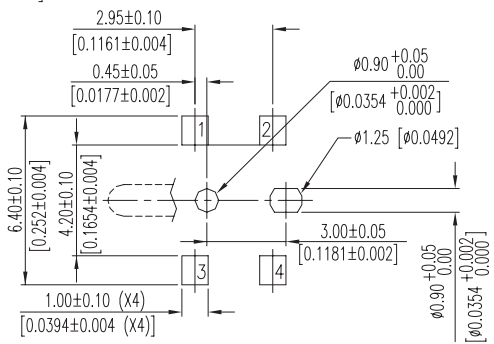
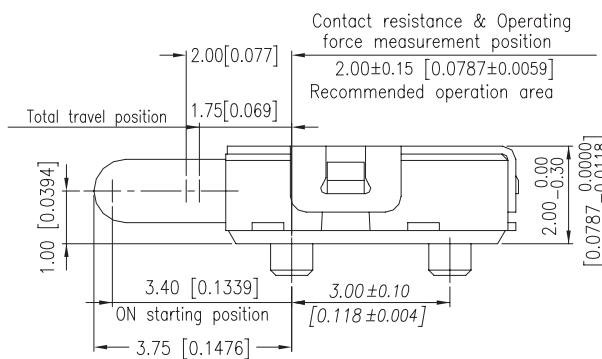
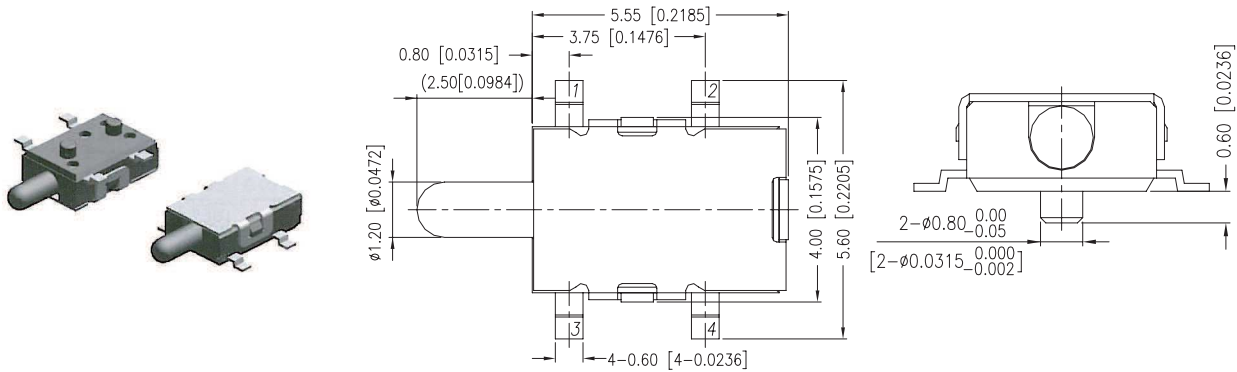

P.C.B LAYOUT

CIRCUIT DIAGRAM

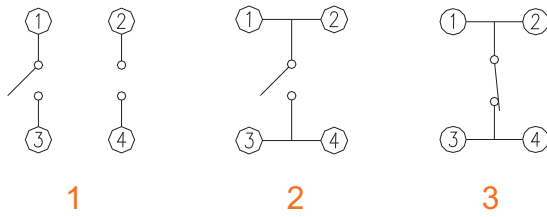

TAPE & REEL PACKAGING

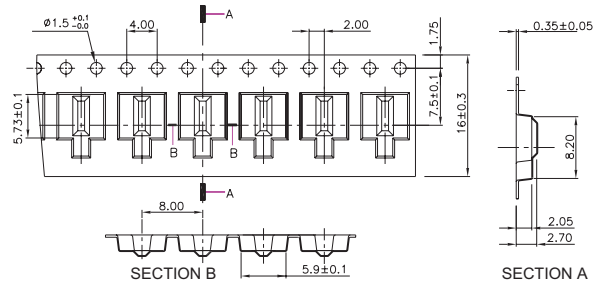

SECTION A

How to order:

DF3 1 2 3 4

1 CIRCUIT DIAGRAM:

- 1 See above drawings
- 2 See above drawings
- 3 See above drawings

2 POST:

- N Without Post
- P With Post

3 CONTACT MATERIAL:

- AG Silver Plating
- AU Gold Plating

4 PACKAGE STYLE:

- TR Tape & Reel

General Specifications:

MATERIALS

- » Contact: Stainless Steel With Silver/Gold Plated
- » Terminal: Brass With Silver/Gold Plated
- » Cover: Stainless Steel
- » Base & Stem: UL94V-0Nylon High-Temp Thermoplastic
- » Spring: Piano Wire

MECHANICAL

- » Operation Force: 50 gf max.
- » Operation Temperature: -40°C to +85°C

ELECTRICAL

- » Electrical Life: 100,000 cycles
- » Rating: 1mA, 5VDC
- » Contact Resistance: 2Ω max
- » Insulation Resistance: 100M Ω min
- » Dielectric Strength: 100VAC / 1 minute

SOLDERING PROCESSES

- » Reflow Soldering: When applying reflow soldering, the peak temperature or the reflow oven should be set to 260°C 10 seconds max.
- » Hand Soldering: use a soldering iron of 30 watts, controlled at 350°C approximately max 5 seconds while applying.