

# Rotary Switches

## Rotary Switches

## RB1 Series

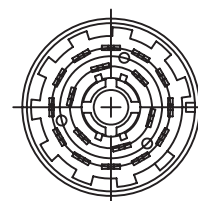
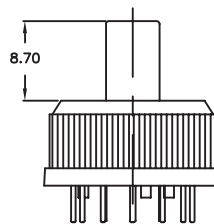
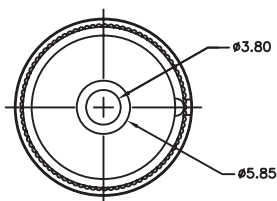

### SWITCHING COMBINATION

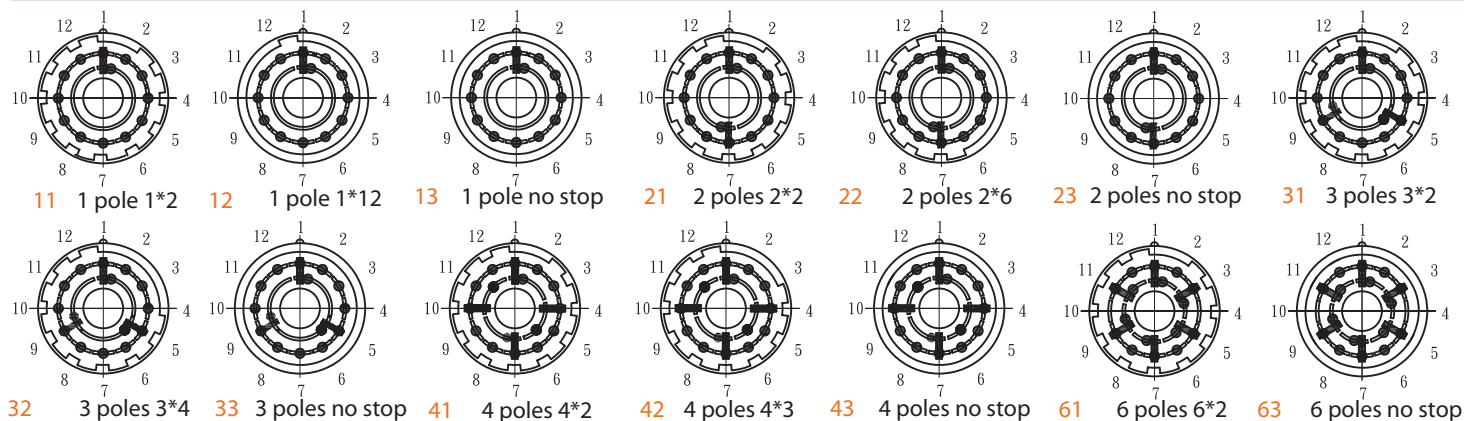

### ACTUATOR OPTIONS

### P. C. MOUNTING & CIRCUIT

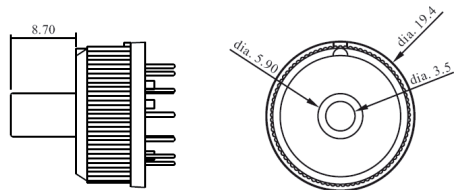

**E** Extended Actuator

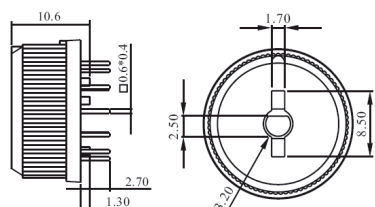

**R** Recessed Actuator

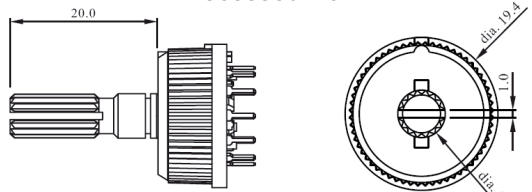

**L** Extended Actuator

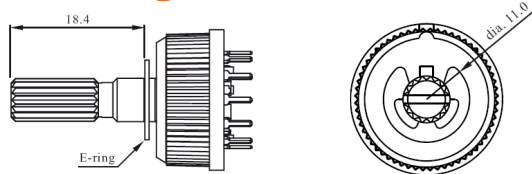

**L1** Extended Actuator with E-ring

1 pole

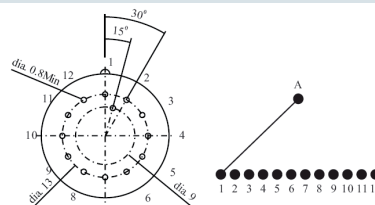

2 poles

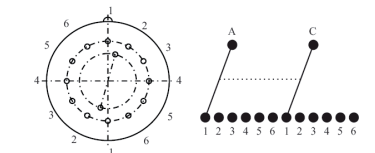

3 poles

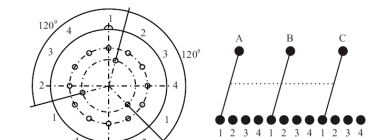

4 poles

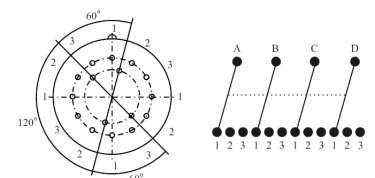

6 poles

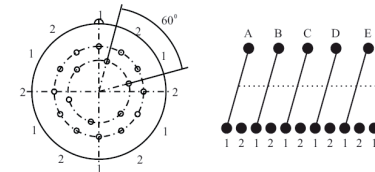

### How to order:



1	ACTUATOR:	2	SWITCHING COMBINATION:	3	OPERATING MODE:
E	Extended	11	12 13 21 22	S	Shorting (Make before break)
R	Recessed	23	31 32 33 41	N	Non Shorting (Break before make)
L	Extended	42	43 61 63		
L1	Extended with E-ring				

### General Specifications:

- Voltage Rating: 150 VDC
- Current Rating: 130mA
- Insulation Resistance: 100MΩ Min.
- Indexing Angle: 30°
- Operating Life no load: 20,000 cycles Min.
- Operating Life at Maxpower: 15,000 cycles Min.
- Solder Specification: 250°C 5 seconds
- Operating Force: 1 kgf<sub>cm</sub> (Max.)
- Operating Temperature\*: -25°C to +85°C

All specifications are restricted to QA test criteria. DRW: D. L. JIN, CHK: D.F. LEE, APP: H.Z. QIU, DC: 2010-02-02 UPD: 2013-05-03; \*2015-06-16 / 2025-05-13.