

Potentiometers

Rotary Potentiometer with Metal Shaft

GP85 Series

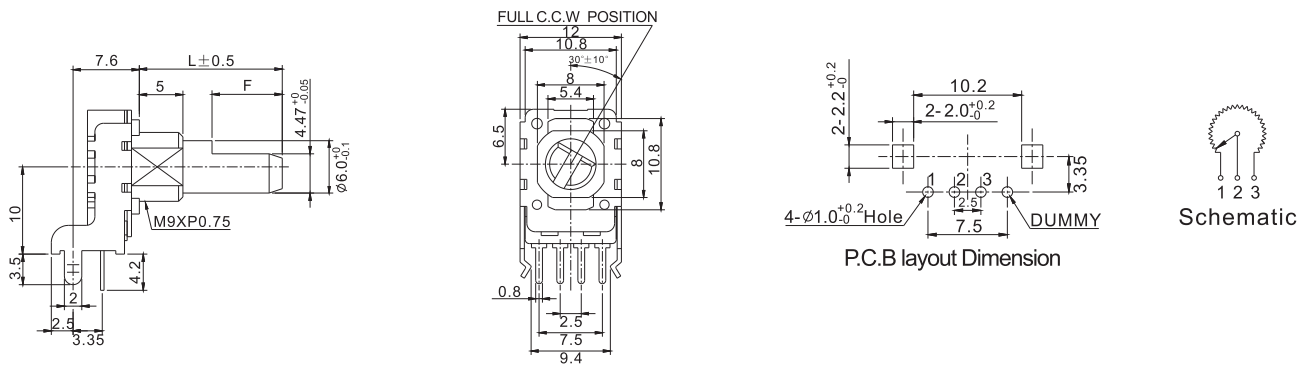

GP85NS1B... 1 Gang, Side Adjust, Height 10mm, With M9 Bushing

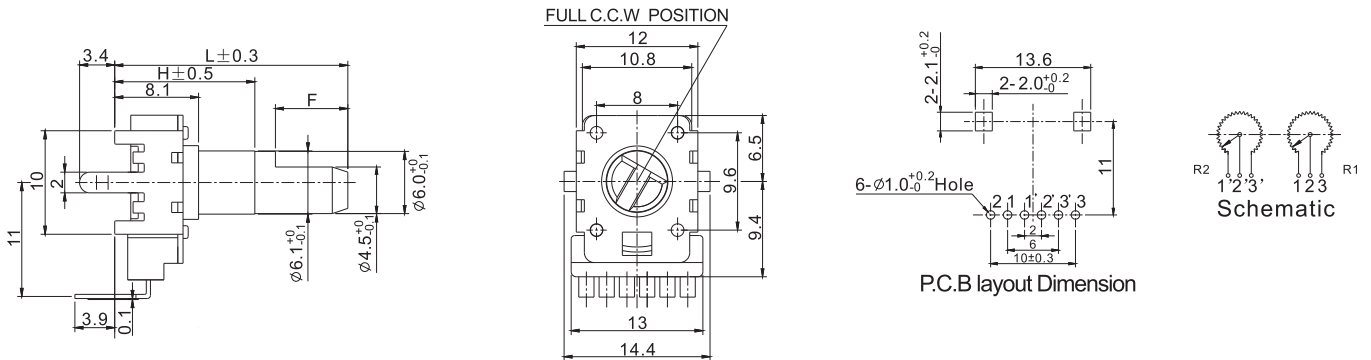

GP85GT0N... Dual Gangs, Top Adjust, No Bushing

SPECIFICATIONS:

Electrical characteristics

- Total Resistance.....1K Ω ~1M Ω
- Total Resistance Tolerance.....500 Ω <R<1M Ω : $\pm 20\%$
R $\leq 500\Omega$ or R $\geq 1M\Omega$: $\pm 30\%$
- Resistance Taper.....A,B,C
- Max. Operating Voltage(Single Unit/ Dual Unit).AC 50V , DC 20V / AC 30V
- Rated Power(Single Unit/ Dual Unit).....0.05W /0.025W
- Rotational Noise.....Less than 100mV
- Insulation Resistance(Single Unit/ Dual Unit).....More than 100M Ω at DC 500V/
More than 100M Ω at DC 250V
- Withstand voltage(Single Unit/ Dual Unit).....1 minute at AC 500V / 1 minute at AC 300V
- Residual Resistance.....Term.1~2:Less than 20 Ω ; Term.2~3:Less than 20 Ω
- Gang error(Dual Unit).....40dB~0dB ± 3 dB

Mechanical characteristics

- Total Rotational Angle.....300 $^{\circ}$ $\pm 10^{\circ}$
- Rotational Torque.....20 gf.cm ~100 gf.cm
- Click Torque.....50gf.cm~180gf.cm
- Stopper Strength.....3.0Kgf.cm Min.
- Push-Pull Strength.....8.0Kgf Min

Durability

- Rotational Life.....Standard life: 15,000 Cycles Min.
Long life: 100,000 Cycles Min.

How to order:

GP85

- | | | |
|--------------------------------------|-----------------------------|--|
| 1 GANG: | 4 BUSHING: | 7 SHAFT TYPE & LENGTH: |
| N 1 Gang | N Without Bushing | ... (See Note 3) |
| G 2 Gangs | B With Bushing | |
| 2 OPERATION DIRECTION | 5 DETENT OPTION: | 8 RESISTANCE TAPER: |
| T Top Adjust | 0 No Detent | A Audio (15A) |
| S Side Adjust | 1 Center Detent | B Linear (Single unit: 1B; Dual Gangs: 3B) |
| 3 HEIGHT (Note 2): | 2 11 Detents | C Reverse Audio (15C) |
| 0 for Top Adjust Type only | 3 21 Detents | D Audio (10A) |
| 1 10mm (for Side Adjust Type only) | 6 FULL CCW POSITION: | 9 TOTAL RESISTANCE: |
| 2 12.5mm (for Side Adjust Type only) | ... (See Note 1) | ... 1K - 1MEG |

All specifications are restricted to QA test criteria.
DRW: J.Y. GONG CHK: Y.F. YAN APP: Z.W. LI DC: 2013-06-20. UPD: 2025-05-19.

Potentiometers

Rotary Potentiometer with Metal Shaft

GP85 Series

Note 1: Full C.C.W position

F-Type Shaft

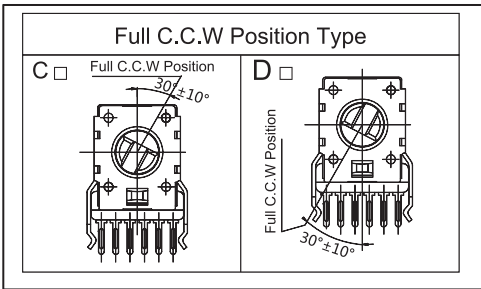

Y-Type Shaft

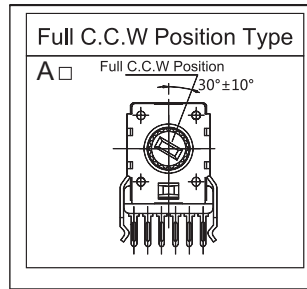

Note 2: Height (H)

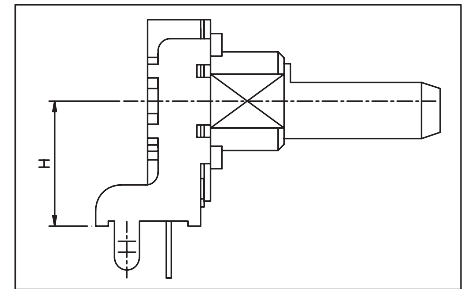

Note 3: Shaft Type & Shaft Length:

F-Type

Without Bushing

	1	2	3	4	5	6	7	8	9	0
L	15	18	20	22.5	24.5	25	27.5	30	32.5	36.2
F	4.5	7	7	7	11.5	12	12	12	12	12
H	10.5	10.5	13	13	13	13	13	13	13	13

Horizontal type

With Bushing

	1	2	3	4	5	6	7		
L	12.5	15	17.5	20	22.5	25	28.7		
F	7	7	12	12	12	12	12		

Horizontal Type

Y-Type

Without Bushing

	1	2	3	4	5	6	7	8	
L	15	20	22.5	24.7	27.5	29.7	32.5	35	
I	5	7	7	12	12	12	12	12	

Horizontal Type

With Bushing

	1	2	3	4	5	6	7		
L	12.5	15	17.2	20	22.2	25	27.5		
I	7	7	12	12	12	12	12		

Horizontal Type