

# Tactile Switches

6.2x6.2mm Washable Tactile Switch

TP1W\_02 Series

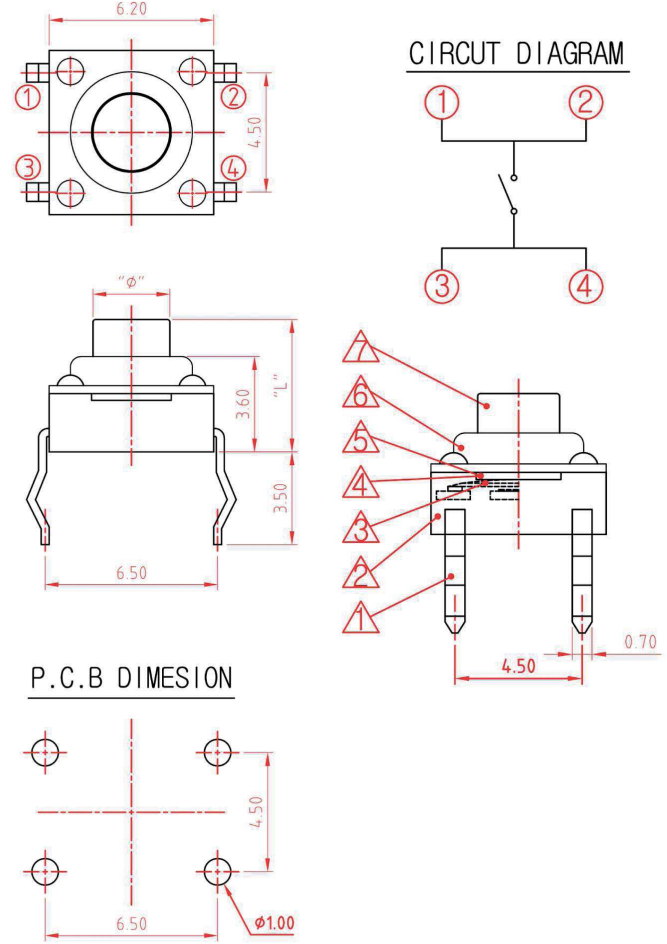
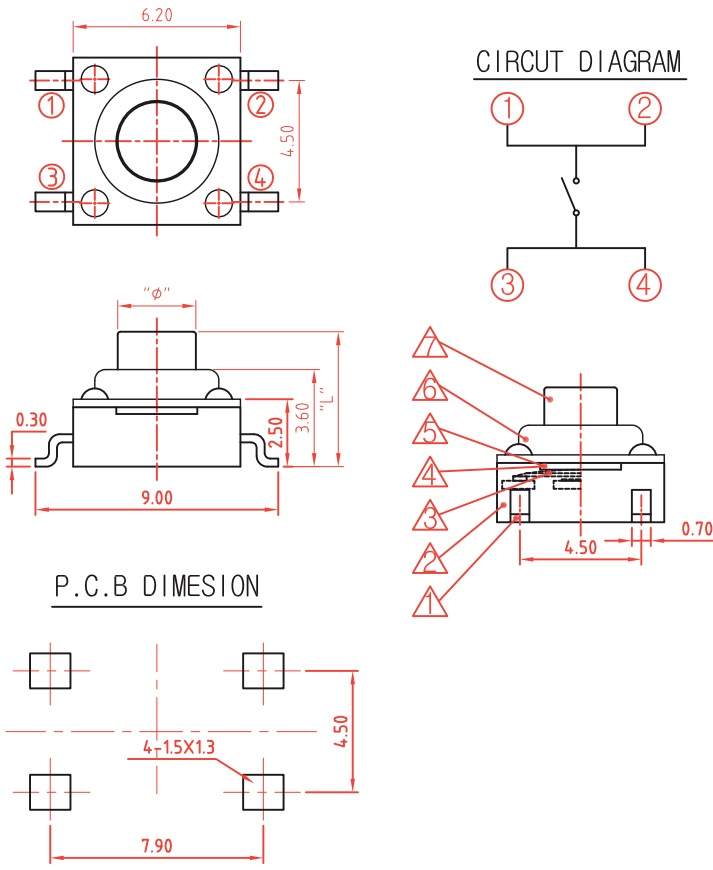

UNIT: mm

## SPECIFICATIONS:

- > Rating: 50mA 12VDC Max.
- > Contact Resistance: 100 mohm Max.
- > Insulation Resistance: 100 Mohm Min. at 100VDC
- > Dielectric Strength: 250VAC 1 Minute
- > Operating Life: 100,000 Cycles Min.
- > Stroke: 0.2±0.10 mm
- > Operating Temperature: -40°C ~ +85°C
- > Protection Degree: IP67 (In house test)

## MATERIALS:

- > 1. Terminal: C2680, Silver Plating
- > 2. Case: Nylon6T
- > 3. Contact: Stainless Steel
- > 4. Tape: Polyimide
- > 5. Rubber: Silicone
- > 6. Cover: C2680, Silver Plating
- > 7. Stem: Nylon6T

Tolerance unless otherwise stated: ±0.2mm  
Solder thickness: 0.10mm

## SOLDERING CONDITIONS:

### > SMT

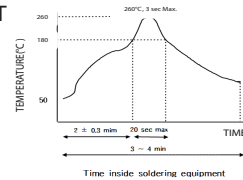

### > Manual Soldering

Soldering Temperature: 350°C Max.  
Continuous Soldering Time: 3 Sec. Max.

### > Auto Dip Soldering

Flux Built-Up: Mounting surface should not be coated with flux.  
Preheating: Ambient temp. of the soldered surface of PC 100°C Max.  
45 Sec. Max.

Soldering Temperature: 255°C Max.  
Continuous Dipping Time: 5 Sec. Max.  
Number of Soldering: 2 times Max.

## How to order:

TP1W 1 2 3 4 5 02

- |                     |                            |                           |                       |                      |
|---------------------|----------------------------|---------------------------|-----------------------|----------------------|
| <b>1</b> TERMINALS: | <b>2</b> TOTAL HEIGHT "L": | <b>3</b> OPERATING FORCE: | <b>4</b> STEM COLOR*: | <b>5</b> PACKAGING:  |
| S SMT               | 43 4.3mm (Blue)            | K 160gf                   | A Black               | BK Bag (THT)         |
| H THT               | 50 5.0mm (Gray or Black)   | C 250gf                   | B White               | TR Tape & Reel (SMD) |
|                     | 70 7.0mm (Black)           |                           | H Gray                |                      |
|                     | 95 9.5mm (Black)           |                           | G Blue                |                      |

\* according to different types and height.

