

Tactile Switches

12x12mm Washable Halogen-free Tactile Switches

TP57 Series

General Specifications



MECHANICAL

- » Stroke : 0.35±0.1 mm
- » Operating Temperature Range: -40°C to +80 °C
- » Storage Temperature Range: -40°C to +85°C

ELECTRICAL

- » Rating: 50mA, 24VDC
- » Contact Resistance: 100mΩ Max
- » Insulation Resistance: 100MΩ Min. at 250 VDC
- » Dielectric Strength: 250VAC / 1 minute
- » Contact Arrangement: 1P1T
- » Electrical Life: 1,000,000 cycles for 160/260gf.
300,000 cycles for 320/520gf.

MATERIALS

- » Cover: Stainless Steel
- » Stem: UL94V-0 High-Temp. Thermoplastic
- » Base: UL 94V-0 High Temp Thermoplastic black
- » Contact: Stainless Steel
- » Terminal: Brass with silver plated
- » Sealed Gasket: Silicone black min.
- » Halogen-Free Materials:
 - Br < 900 ppm
 - Cl < 900 ppm
 - Br+Cl < 1500 ppm
- » IP67 ▲

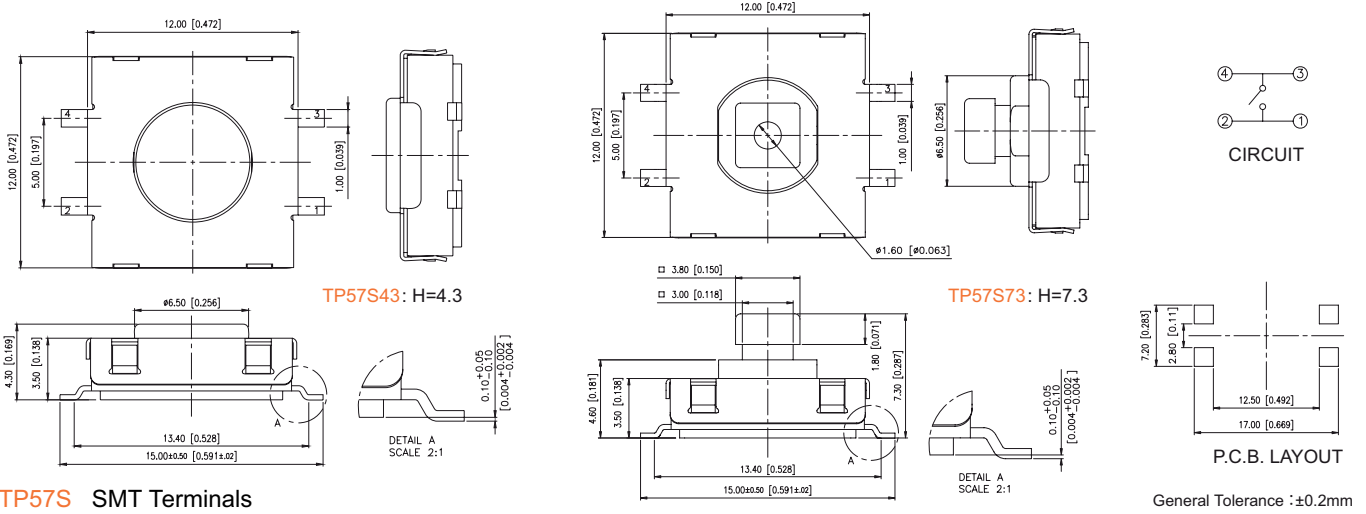

TP57S SMT Terminals

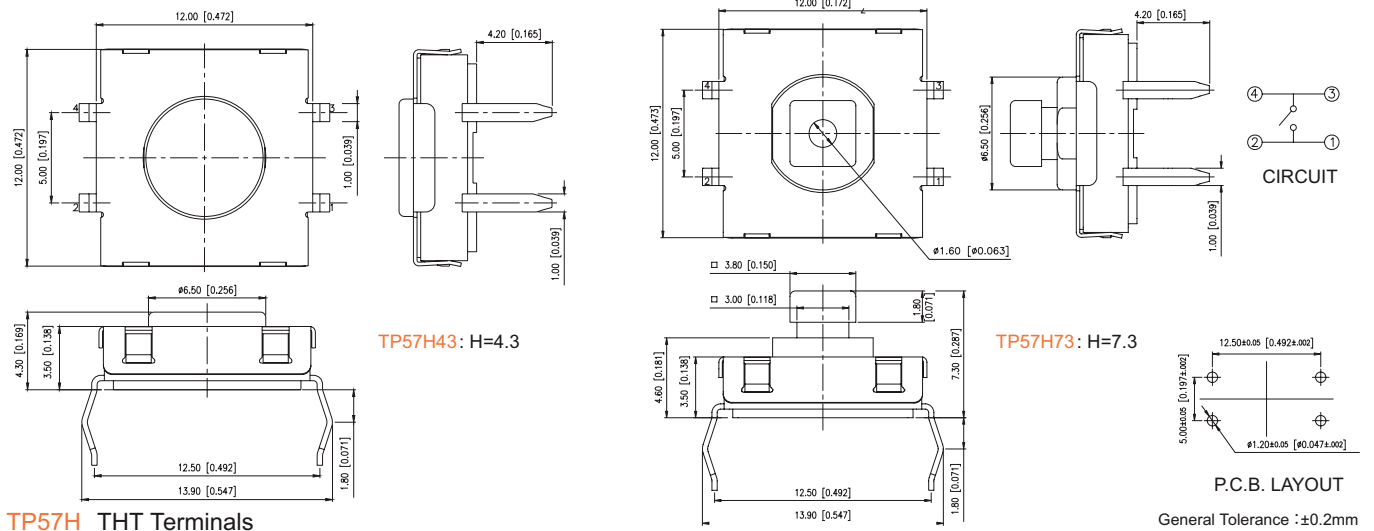

TP57H THT Terminals

How to order:

TP57 +

1 TERMINAL TYPE:

- H THT Terminals
- S SMT Terminals

2 HEIGHT:

- 43 4.3mm
- 73 7.3mm (square actuator for optional cap)

3 STEM COLOR & OPERATING FORCE: ▲

- K Brown & 160±50gf
- C Red & 260±50gf
- J White & 320±80gf ▲
- E Yellow & 520±130gf

4 PACKAGING:

- BK Bulk (TP57H... only)
- TR Tape & Reel
- TB Tube

Optional:

- 5 CAP TYPE (Only for Square Stems):

- K12S Square Caps
- K12R Round Caps

6 COLOR OF CAPS:

- A Black
- B Ivory
- C Red
- E Yellow
- F Green
- G Blue
- H Gray
- S Salmon

▲ Revised 2010-10-14

General Tolerance: +/-0.2mm

All specifications are restricted to QA test criteria.
 DRW: D. L. JIN, CHK: D.F. LEE, APP: H.Z. QIU, DC: 2010-10-14, UPD: 2025-04-07.

Tactile Switches

12x12mm Washable Halogen-free Tactile Switches

TP57 Series

OPTIONAL CAPS

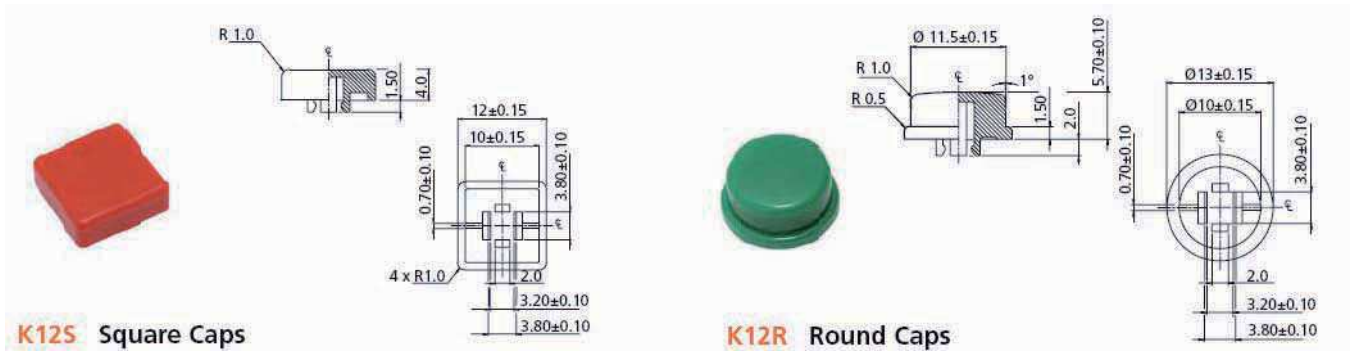

K12S Square Caps

K12R Round Caps

SOLDERING PROCESS

- » Wave Soldering: Recommended solder temperature at 260°C max. 5 seconds subject to PCB 1.6mm thickness (soldering for through hole type).
- » Hand Soldering: Use a soldering iron of 30 watts, controlled at 350°C approximately 5 seconds while applying solder.
- » Reflow Soldering : When applying reflow soldering, the peak temperature or the reflow oven should be set to 260°C max.

» Temperature Profile :

