

Tactile Switches

Keyswitch LED Illuminated

TPS Series

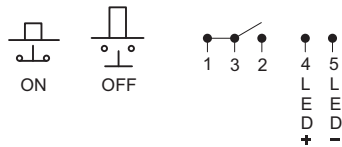
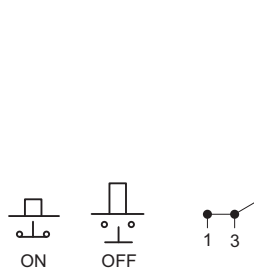

CIRCUIT

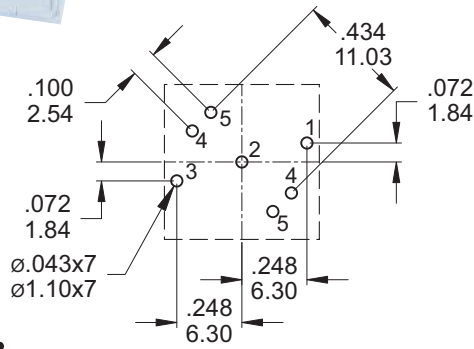

TPS15A CAP Type
TOP VIEW

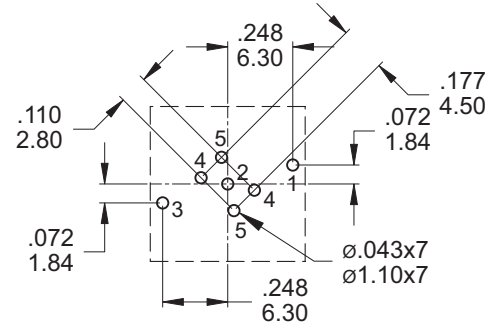

TPS15B/C CAP Type
TOP VIEW

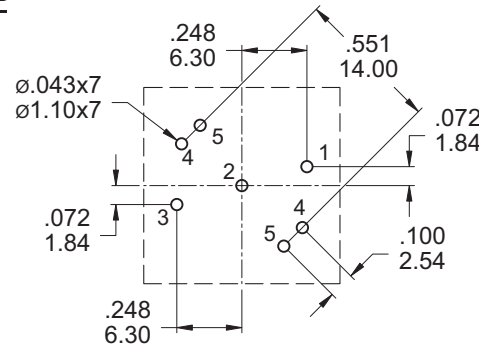

TPS19A CAP Type
TOP VIEW

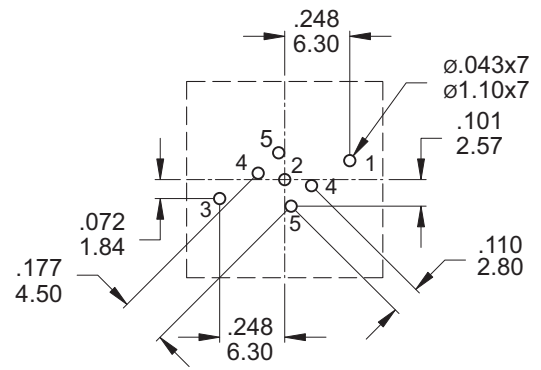

TPS19B/C CAP Type
TOP VIEW

SPECIFICATIONS:

- > Rating: 100mA 24VAC/DC
- > Contact Resistance: 100 mohm Max.
- > Insulation Resistance: 1000 Mohm Min.
- > Dielectric Strength: 1000VAC
- > Electrical Life: 1,000,000 Cycles
- > Stroke: 0.15±0.10 mm
- > Operating Temperature*: -40°C ~ +85°C

MATERIALS:

- > Actuator: ABS
- > Terminals: Brass, Au plated
- > Terminal Seal: Epoxy
- > Contact: Stainless Steel, Au plated
- > Transparent: PC
- > Housing: PBT

How to order:

TPS



1 SIZE:

- 15 15x15mm
- 19 19x19mm

2 ACTUATOR TYPE

- A Transparent
- B Color Actuator
- C O.H Actuator

3 ACTUATOR COLOR:

- B White
- C Red
- E Yellow
- F Green
- G Blue

4 LED:

- 0 No LED
- 1 One LED
- 2 Two LED

5 LED1 COLOR:

- (B,C Type Actuator only)
- N No LED
- B White
- C Red
- E Yellow
- F Green
- SF Superbright Green
- G Blue

6 LED2 COLOR:

- (A Type Actuator only)
- N No LED
- B White
- C Red
- E Yellow
- F Green
- SF Superbright Green
- G Blue

7 CONTACT MATERIAL:

- AU Gold
- AG Silver

Tactile Switches

Keyswitch LED Illuminated

TPS Series

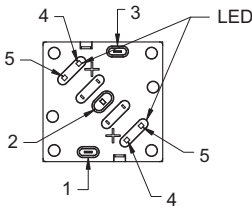
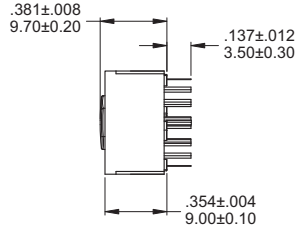
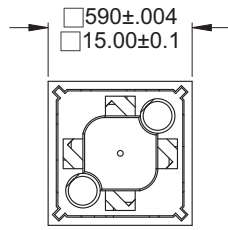

TPS15A

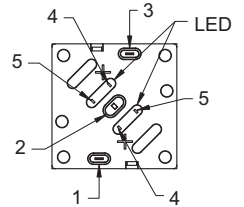
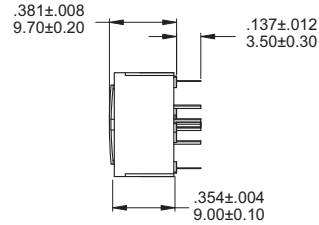
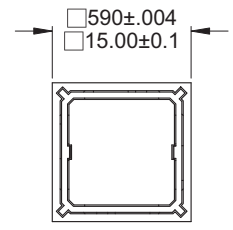

TPS15B

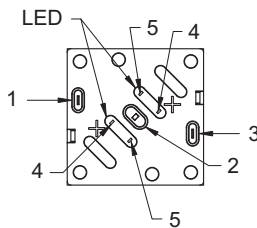
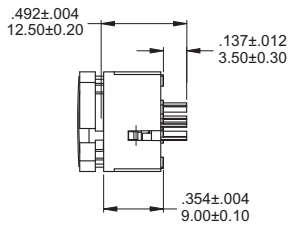
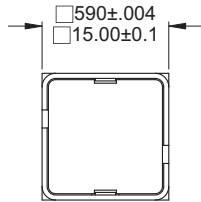

TPS15C

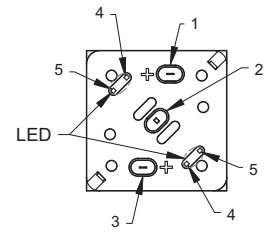
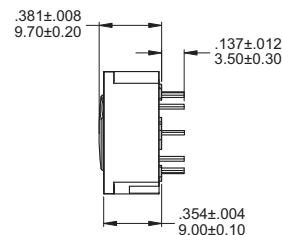
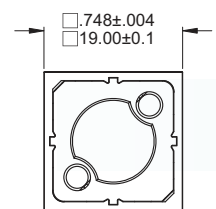

TPS19A

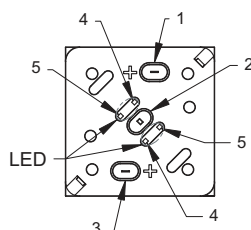
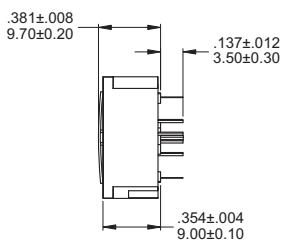
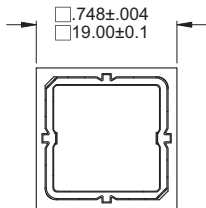

TPS19B

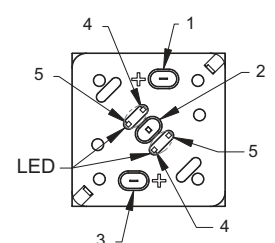
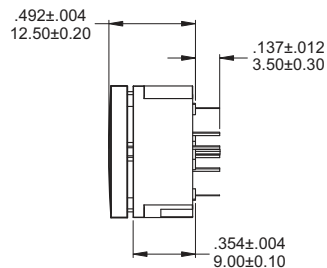
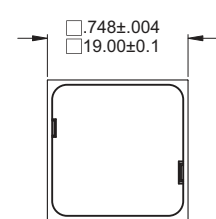

TPS19C

1st Set LED Color							
Lens Appearance	Color	Electro-optical Data(AT 20mA)				Peak wavelength	Viewing Angle 2θ 1/2 (deg)
		Vf (V)		Iv (mcd)			
		Typ.	Max.	Typ.	Min.		
Water Clear	White	3.2	3.7	270	160	635	150°
	Red	2.0	2.5	95	50		
	Yellow	2.0	2.5	150	80		
	Green	2.0	2.5	45	25		
	Blue	3.1	3.6	50	20		
2nd Set LED Color							
Lens Appearance	Color	Electro-optical Data(AT 20mA)				Peak wavelength	Viewing Angle 2θ 1/2 (deg)
		Vf (V)		Iv (mcd)			
		Typ.	Max.	Typ.	Min.		
Water diffused	Cool White	3.3	4	3300	2200	635	45°
Red diffused	Super Bright Red	2.05	2.6	850	460	630	45°
Yellow diffused	Super Bright Yellow	2.0	2.6	500	220	590	40°
Green diffused	Green	2.0	2.6	150	63	575	40°
Blue diffused	Super Bright Blue	3.5	3.8	1300	690	468	45°

*The LED specification for reference only