

# Tactile Switches

## 3.5x6 mm SMT Tactile Switch

## TP75 Series

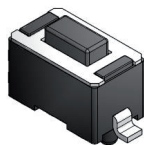

**TP75E** 2 3 4 5

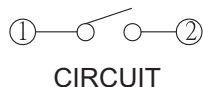

UNIT: mm

Tolerance unless otherwise stated:

±0.15mm (within 0.XXmm)

±0.25mm (within 0.Xmm)

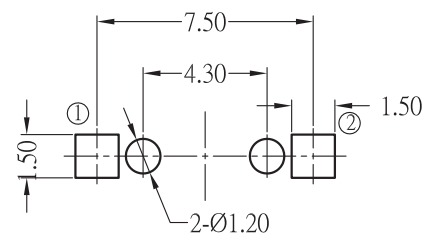
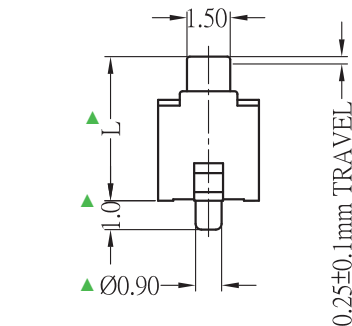
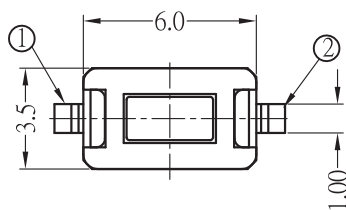
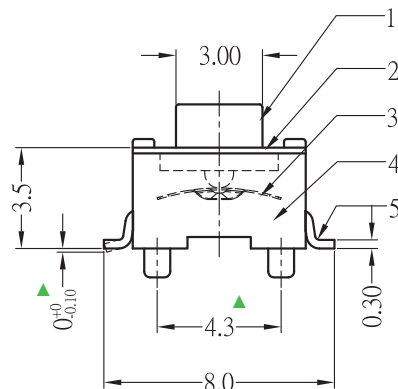

**P.C.B. LAYOUT**

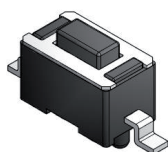

**TP75S** 2 3 4 5

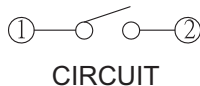

UNIT: mm

Tolerance unless otherwise stated:

±0.15mm (within 0.XXmm)

±0.25mm (within 0.Xmm)

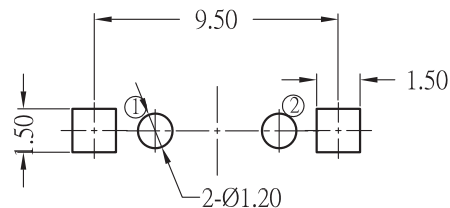
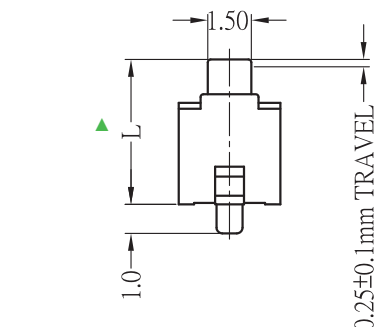
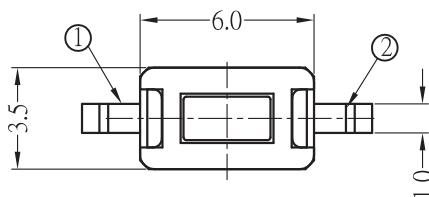
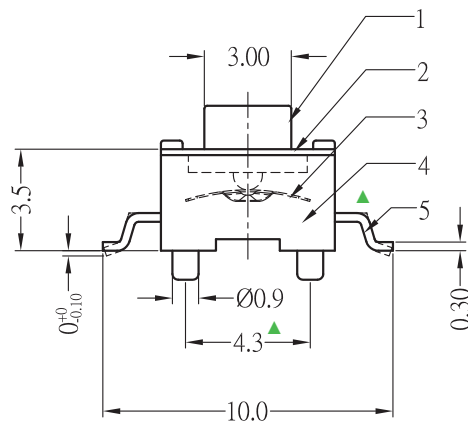

**P.C.B. LAYOUT**

### HOW TO ORDER:

**TP75**



#### 1 TERMINALS:

- E SMT Terminal Length 8 mm
- S SMT Terminal Length 10 mm

#### 2 TOTAL HEIGHT "L":

- N 4.3 mm
- A 5.0 mm

#### 3 OPERATING FORCE:

- 130 130±30gf
- 180 180±30gf
- 250 250±50gf

#### 4 STEM COLOR:

- No Code Black Stem (Black Case)
- AB Black Stem (White Case)
- BA White Stem (Black Case)
- BB White Stem (White Case)

#### 5 PACKAGING:

- TR Tape & Reel

### SPECIFICATIONS:

- > Rating: 50mA 12VDC
- > Contact Resistance: 50 mohm Max.
- > Insulation Resistance: 100 Mohm Min. at 100VDC for 1 Minute
- > Dielectric Strength: 250VAC (50~60Hz) for 1 Minute
- > Stop Strength: 1kgf Max. vertical static 15 Seconds
- > Stroke: 0.25±0.10mm
- > Operating Life: 50,000 Cycles (130gf & 180gf)  
30,000 Cycles (250gf)
- > Operating Temperature: -25°C ~ +70°C
- > Reflow Soldering: 260°C 3 Seconds Max.

### MATERIALS:

- 1. Stem: PA6T
- 2. Cover: SUS430
- 3. Contact: SUS Silver plated
- 4. Case: PA6T
- 5. Terminals: Brass Strip Silver coating

### PACKAGING:

- > Tape & Reel Packaging: 1,000 PCS per Reel