

Tactile Switches

SPST THT Tactile Switches with LED

TPN Series

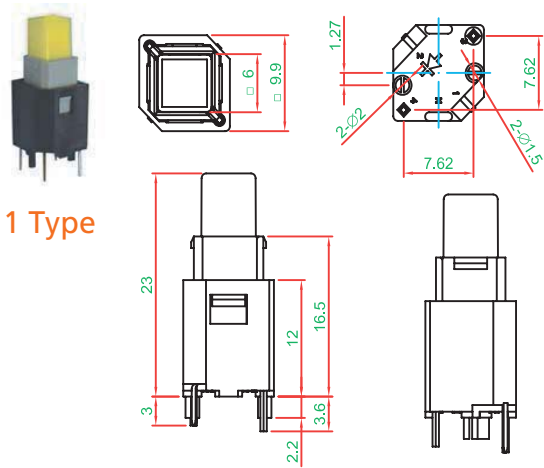

1 Type

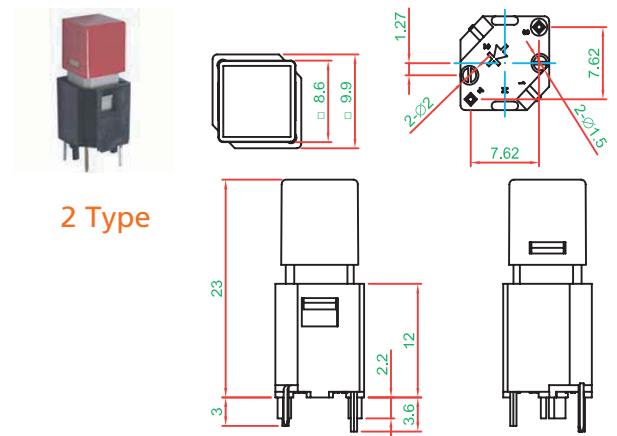

2 Type

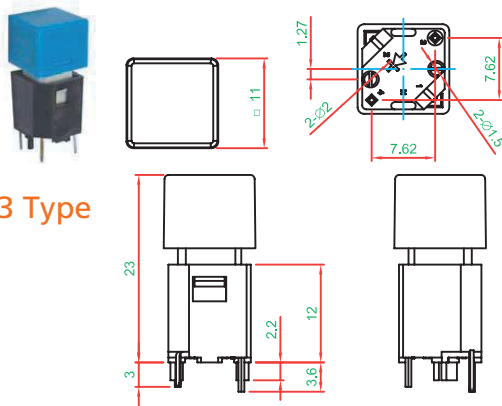

3 Type

▶ P.C.B. LAYOUT

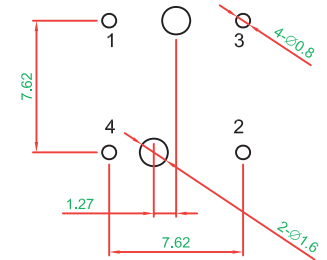

▶ CIRCUIT DIAGRAM

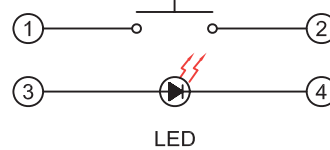

How to order:

TPN

- 1** CAP:
 - 1 1 Type (s. drawings)
 - 2 2 Type (s. drawings)
 - 3 3 Type (s. drawings)
- 2** CAP COLOR:
 - B White
 - C Red
 - G Blue
 - J Transparent
- 3** CAP SURFACE:
 - S Silver
 - N Without
- 4** CAP SYMBOL:

N	WITHOUT
01	02 +
03	04 ↑
05	06 ←
07	08 ↻
09	10 OK
- 5** LEFT LED BRIGHTNESS:
 - U Ultra Bright
 - R Regular
 - N Without LED
- 6** LEFT LED COLORS:
 - G Blue F Green B White
 - E Yellow C Red
- 7** RIGHT LED BRIGHTNESS:
 - U Ultra Bright
 - R Regular
 - N Without LED
- 8** RIGHT LED COLOR:
 - G Blue F Green B White
 - E Yellow C Red

General Specifications:

SWITCH SPECIFICATIONS	
POLE - POSITION	Momentary Type , SPST with LED
CONTACT RATING	12 V DC , 50 mA
CONTACT RESISTANCE	500 mΩ max . 1.5 V DC ; 100 mA , by Method of Voltage DROP
INSULATION RESISTANCE	100 MΩ min . 100 V DC for 1 minute
DIELECTRIC STRENGTH	Breakdown is not Allowable ; 250 V AC for 1 Minute
OPERATING FORCE	350 gf +/- 100gf
OPERATING LIFE	30,000 cycles
OPERATING TEMPERATURE RANGE	-20°C ~ 70°C
TOTAL TRAVEL	1.4 + 0.2 / - 0.1 mm

LED SPECIFICATIONS		Unit	Value / LED Color			
			Blue	Green	Red	Yellow
	ATTENTION					
	LEDs are Electrostatic Sensitive devices					
FORWARD CURRENT	I _f	mA	30	30	15	20
REVERSE VOLTAGE	V _r	V	5.0	5.0	5.0	5.0
REVERSE CURRENT	I _r	µA	10	10	10	10
FORWARD VOLTAGE@20mA	V _f	V	3.5-3.8	1.7-2.6	1.7-2.6	1.7-2.6
LUMINOUS INTENSITY@20mA	I _v	mcd	45	6	4	5

All specifications are restricted to QA test criteria.
DRW: D.L. JIN, CHK: D.F. LEE, APP: H.Z. QIU